

# LAKE TYE BUILDING

14090 Fryeland Boulevard, Monroe, WA 98272

**LAST  
Spaces!**

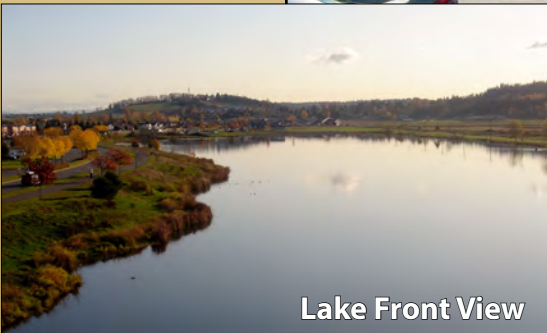

Lake Front View

## Highest Quality Building in Monroe

### \$13.50/SF, NNN

### 957 SF - 4,625 SF Available

#### FEATURES:

- 1<sup>st</sup> & 3<sup>rd</sup> Floors Fully Leased!
- Flexible Suite Sizes Ready for Improvements
- Lake Front with Views
- Two Floors of Office over Ground-Floor Retail
- 4.5 / 1,000 Parking Ratio - Free
- \$7.98 / SF Estimated NNN Expenses

For more information, contact:

ROSEN~HARBOTTLE  
COMMERCIAL REAL ESTATE

**Caleb Farnworth, CCIM**  
(425) 289-2235  
calebf@rosenharbottle.com

www.rosenharbottle.com

Rosen~Harbottle Commercial Real Estate | P.O. Box 5003 Bellevue, WA 98009-5003  
phone: (425) 454-3030 fax: (425) 454-6705 | www.rosenharbottle.com

The information provided has been obtained from sources believed reliable. While we do not doubt its accuracy, we have not verified and make no guarantee, warranty or representation about it. It is your sole responsibility to independently confirm its accuracy and completeness.

# LAKE TYE BUILDING

14090 Fryeland Boulevard, Monroe, WA 98272

## Second Floor - Office

### EXISTING SPACE PLAN



**Flexible Suite Sizes  
for Various Users**

### SAMPLE SPACE PLAN

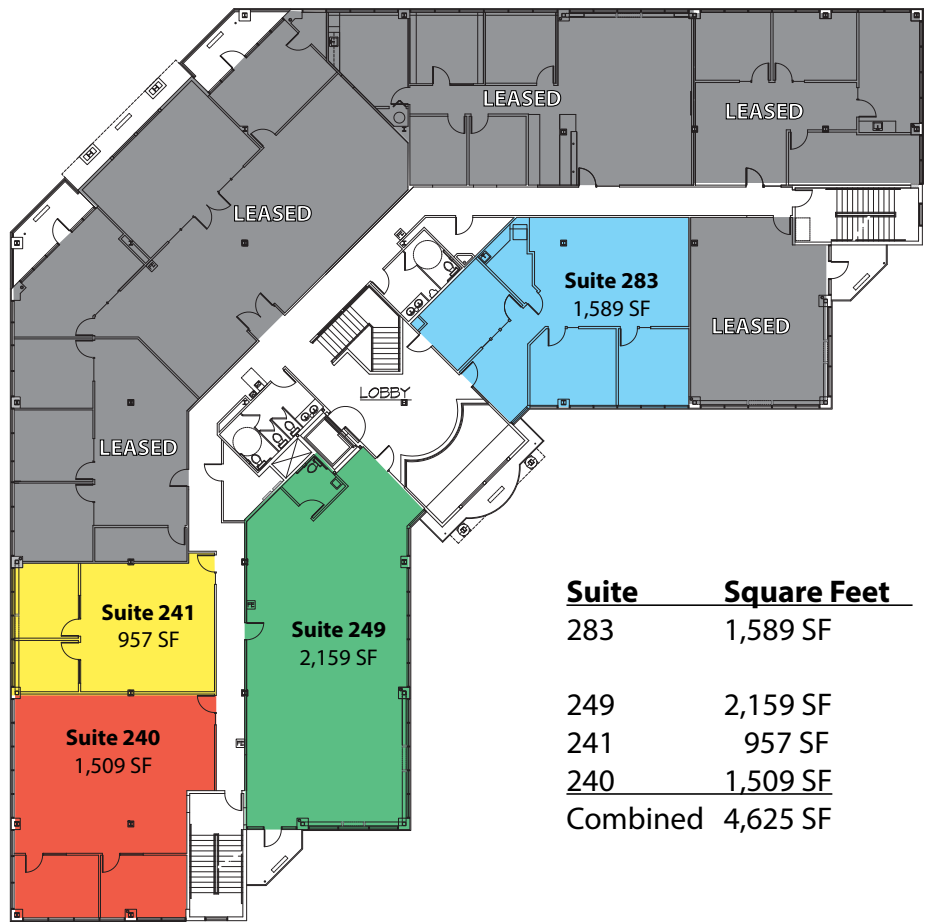

Suite	Square Feet
283	1,589 SF
249	2,159 SF
241	957 SF
240	1,509 SF
Combined	4,625 SF



Rosen~Harbottle Commercial Real Estate | P.O. Box 5003 Bellevue, WA 98009-5003  
 phone: (425) 454-3030 fax: (425) 454-6705 | www.rosenharbottle.com

The information provided has been obtained from sources believed reliable. While we do not doubt its accuracy, we have not verified and make no guarantee, warranty or representation about it. It is your sole responsibility to independently confirm its accuracy and completeness.

# LAKE TYE BUILDING

14090 Fryeland Boulevard, Monroe, WA 98272

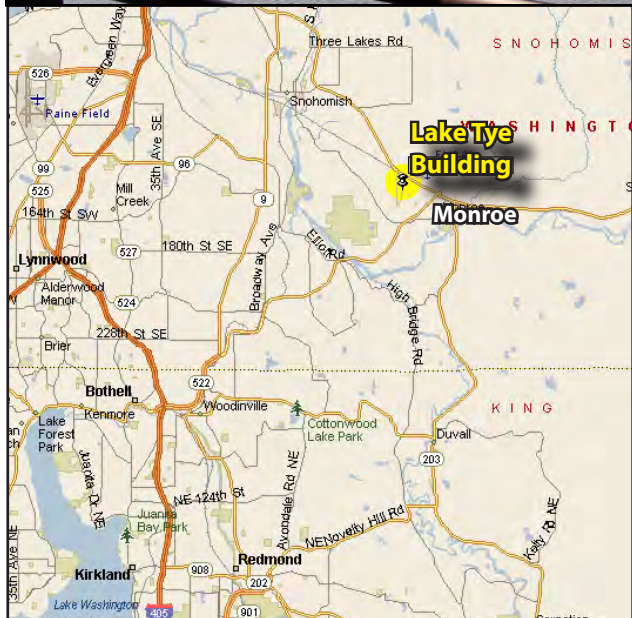

## Rosen | Harbottle

Commercial Real Estate

P.O. Box 5003, Bellevue, WA 98009-5003

(425) 454-3030 Phone (425) 454-6705 Fax

[www.rosenharbottle.com](http://www.rosenharbottle.com)



Rosen~Harbottle Commercial Real Estate | P.O. Box 5003 Bellevue, WA 98009-5003  
phone: (425) 454-3030 fax: (425) 454-6705 | [www.rosenharbottle.com](http://www.rosenharbottle.com)

The information provided has been obtained from sources believed reliable. While we do not doubt its accuracy, we have not verified and make no guarantee, warranty or representation about it. It is your sole responsibility to independently confirm its accuracy and completeness.