

**HIGH-VISIBILITY
RETAIL**



Rodda Paint Building • 7825 Evergreen Way | Everett, WA

Grant Rubenstein
(425) 289-2220
grant@rosenharbottle.com

RH | ROSEN
HARBOTTLE
COMMERCIAL REAL ESTATE

Mimi Rosen
(425) 289-2217
mimi@rosenharbottle.com

EVERGREEN WAY

5,697 SF Available

\$16.00 / SF, NNN

BUILDING DETAILS:

- 5,697 SF Available with 30 Days Notice
 - Currently Occupied by Buddy's Home Furnishings
- New High-Efficiency Lighting
- Prominent Monument Signage on Evergreen Way
- Adjacent to Cascade Plaza Anchored by Safeway, Big Lots and Ross
- 20' Ceilings
- 5.0 / 1,000 SF Parking Ratio



FLOOR PLAN

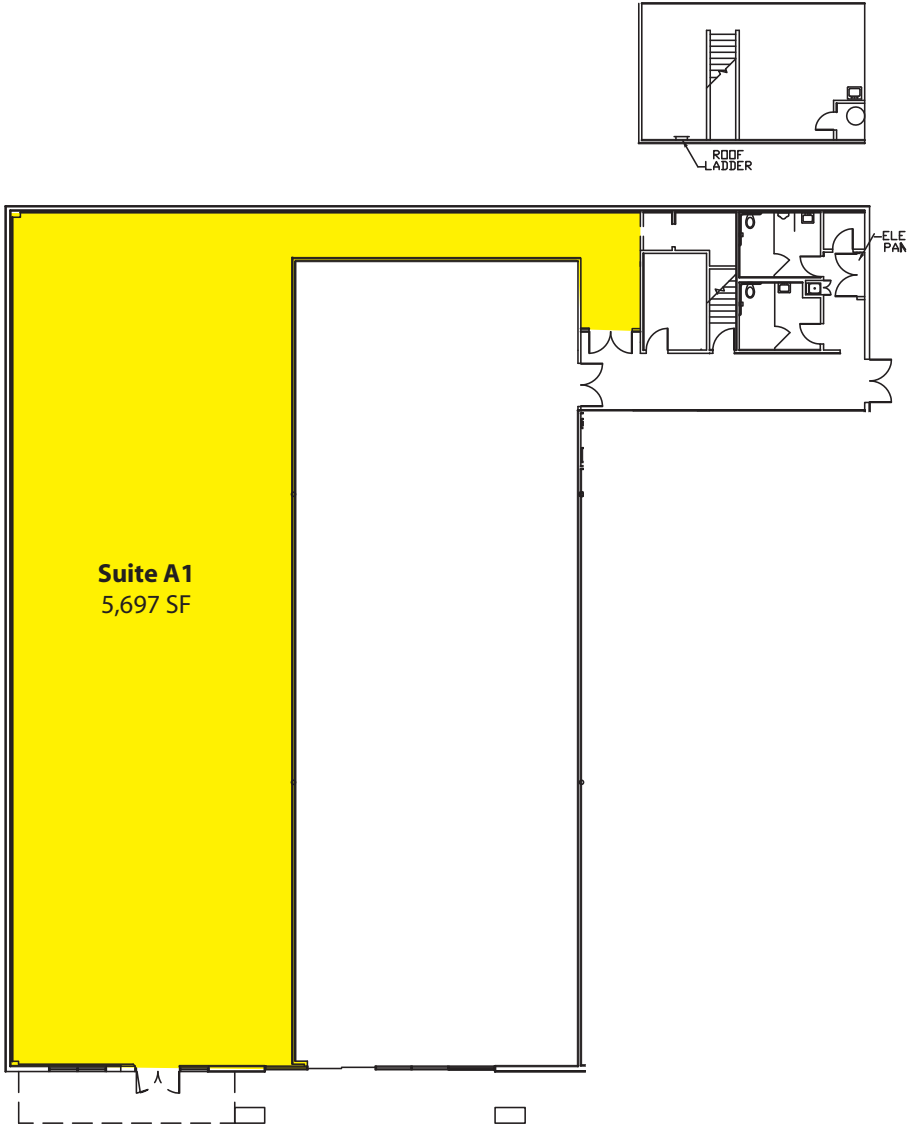

The information provided has been obtained from sources believed reliable. While we do not doubt its accuracy, we have not verified and make no guarantee, warranty or representation about it. It is your sole responsibility to independently confirm its accuracy and completeness.



NEARBY AMENITIES:

- Safeway
- Planet Fitness
- McDonald's
- Chase Bank
- Big 5 Sporting Goods
- Joann Crafts
- Ross Dress for Less
- Big Lots
- Wells Fargo Bank
- Taco Bell
- Fred Meyer
- Starbucks