



TECH/INDUSTRIAL  
LEASE



# RH NORTH CREEK BUSINESS CENTER

11812-11824 North Creek Parkway N | Bothell, WA

**Brian Stewart**

425.289.2222

[brians@rosenharbottle.com](mailto:brians@rosenharbottle.com)

**Caleb Farnworth, CCIM**

425.289.2235

[calebf@rosenharbottle.com](mailto:calebf@rosenharbottle.com)

425.454.3030  
[rosenharbottle.com](http://rosenharbottle.com)

PO Box 5003  
Bellevue, WA 98009 - 5003





# OFFICE/TECH/INDUSTRIAL LOCATED IN CLASS A CORPORATE CAMPUS

2,016 SF - 10,882 SF Available

\$24.00 - \$27.00/SF, NNN

## LOCATION FEATURES:

- On-Site Deli and Childcare
- Nearby Amenities: Restaurants, Retail Shops, Food Trucks, Walking Trails, Sports Fields, and Fitness Center
- Quick Access to I-405, SR-522 & Downtown Bothell



# BUILDING 3 (11824) FLOOR PLAN

## SUITE 101A FEATURES

---

- Available 4/1/2024
- 2,016 SF (533 SF ofc)
- \$24.00/SF, NNN
- Office/Warehouse space
- 1 Restroom
- 1 Grade-Level Roll-up Loading Door

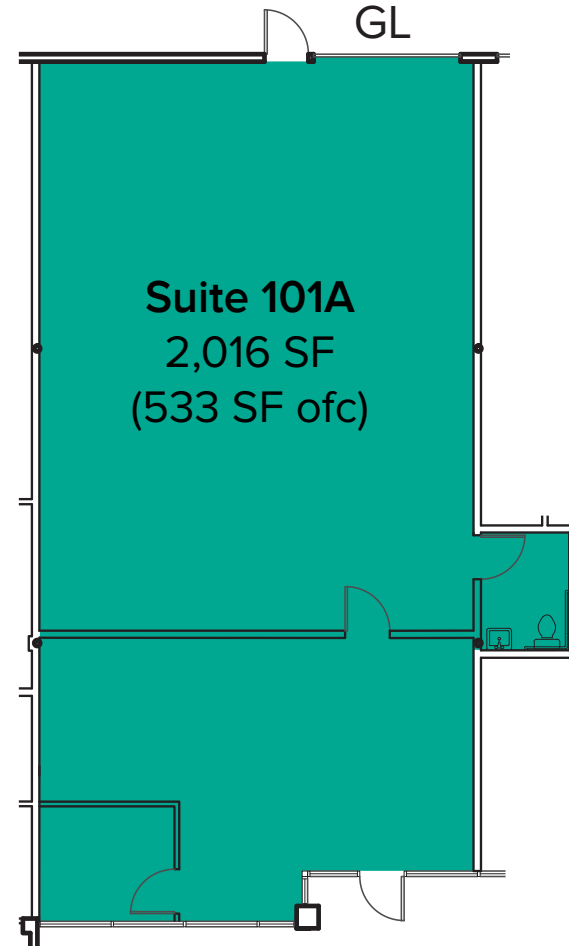

# BUILDING 6 (11822) FLOOR PLAN

Suite	SF	Rate	Notes
106	2,417 SF - 10,882 SF	\$26.00 - \$27.00 SF, NNN	Warehouse/Flex/Light Lab/Tech space. Includes full HVAC, improved flooring, electrical distribution, private rooms, restrooms, break room with kitchenette, and 1 Grade-Level loading door.
107/108	4,045 SF - 10,882 SF	\$26.00 - \$27.00 SF, NNN	Warehouse/Flex/Light Lab/Tech space. Includes full HVAC, improved flooring, electrical distribution, private rooms, restrooms, break room with kitchenette, and 2 Grade-Level loading doors.
109	2,022 SF - 10,882 SF	\$26.00 - \$27.00 SF, NNN	Flex Space with open office; heating and cooling throughout; and 1 RR with shower. 1 GL, 16' CH.
110	2,398 SF - 10,882 SF	\$26.00 - \$27.00 SF, NNN	Endcap office/flex space with open work space and 2 restrooms. HVAC throughout.

Contiguous 10,882 SF (5,044 SF)

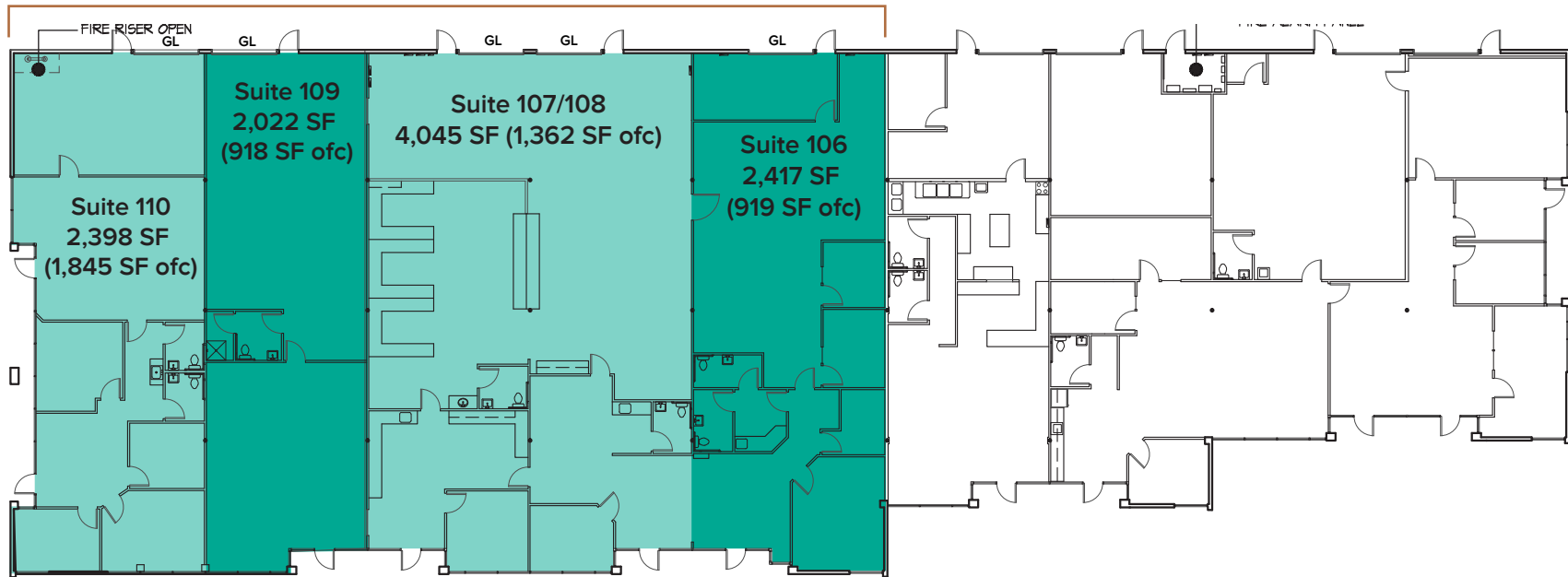

The information provided herein has been obtained from sources believed to be reliable, but no representation or warranty, express or implied, is made with respect to the accuracy or completeness of any such information. Each prospective buyer or tenant should independently investigate, evaluate and verify all information provided herein and any other matters deemed material. Please consult your attorney, tax advisor or other professional advisor. The terms of sale or lease set forth herein are subject to change or withdrawal at any time and without notice.



# CORPORATE NEIGHBORS



## LEGEND:

- 01 AT&T
- 02 Valeant Solta Medical
- 03 General Dynamics
- 04 LuxerCare
- 05 ADT Security
- 06 Google
- 07 Puget Sound Energy
- 08 Genie Industries HQ
- 09 Residence Inn
- 10 Core Design, Inc
- 11 WA State Dept of Revenue
- 12 Byram Healthcare
- 13 Puget Sound Energy
- 14 Tetra Tech
- 15 Verathon