

**WAREHOUSE
LEASE**



EVERGREEN INDUSTRIAL CENTER

19510 144th Avenue NE, Woodinville, WA

Caleb Farnworth, CCIM

425.289.2235

calebf@rosenharbottle.com

425.454.3030
rosenharbottle.com

PO Box 5003
Bellevue, WA 98009 - 5003



LARGE END CAP WAREHOUSE SPACE AVAILABLE

Office: \$1.70/SF, NNN

Warehouse: \$0.90/SF, NNN

13,578 SF (3,928 SF ofc)

FEATURES:

- Available Now
- \$20,000 Improvement Allowance Available
- 20' - 24' Clear Height
- Sprinkled and 3-Phase Power
- Building Signage Along 144th Avenue
- 1 Grade-level Door
- 1 Dock-High Door
- Reception Area, Kichenette, & 2 Restrooms
- Quick Access to SR 522 and I-405

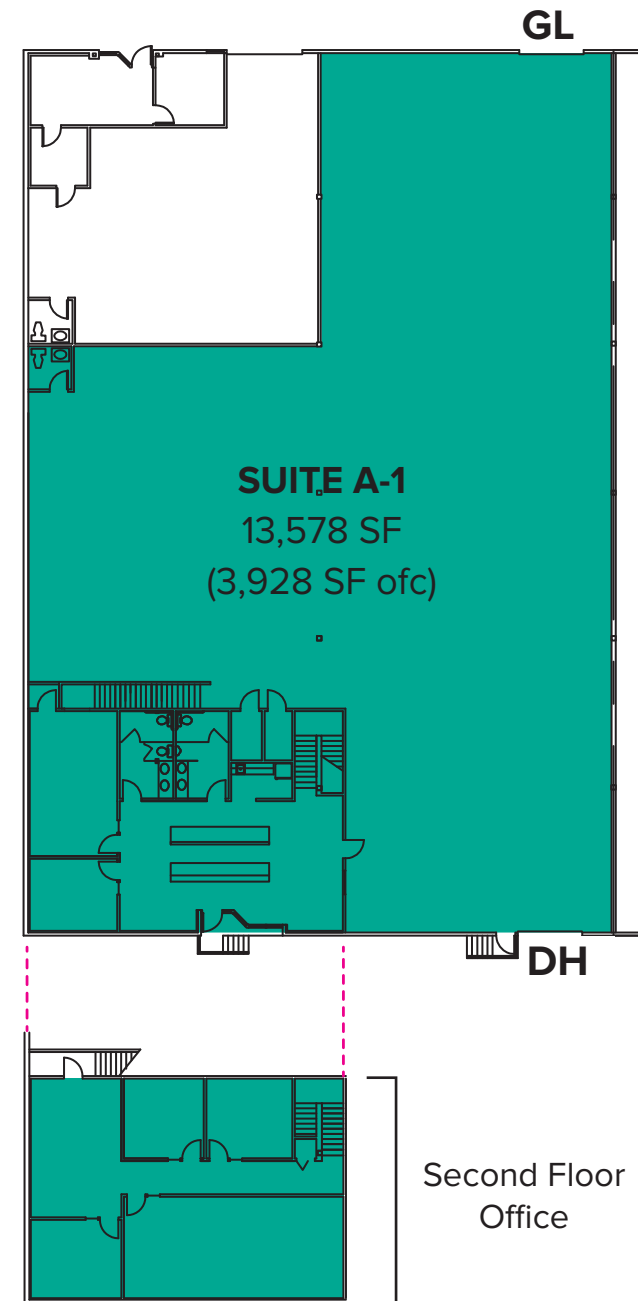

LOCATION MAP

