

RETAIL
LEASE

Available

5th Avenue S

Maple Street

OLD MILL TOWN FORMER EDMONDS HARDWARE & PAINT

201 5th Avenue S | Edmonds, WA

Brian Stewart

425.289.2222

brians@rosenharbottle.com

Jack Rosen

425.289.2221

jack@rosenharbottle.com

425.454.3030
rosenharbottle.com

PO Box 5003
Bellevue, WA 98009 - 5003





LOCATED IN HISTORIC DOWNTOWN EDMONDS

\$16.50/SF NNN

4,760 SF Available

LOCATION DETAILS:

- Building Signage & Dedicated Parking
- Minutes from Edmonds/Kingston Ferry
- Many Amenities within Walking Distance

FLOOR PLAN

AMENITIES & FEATURES:

- High Ceiling with Skylights
- Abundant Natural Light
- Creative Space Ideal for Fitness, Martial Arts, Gallery or Studio
- **Available Now**

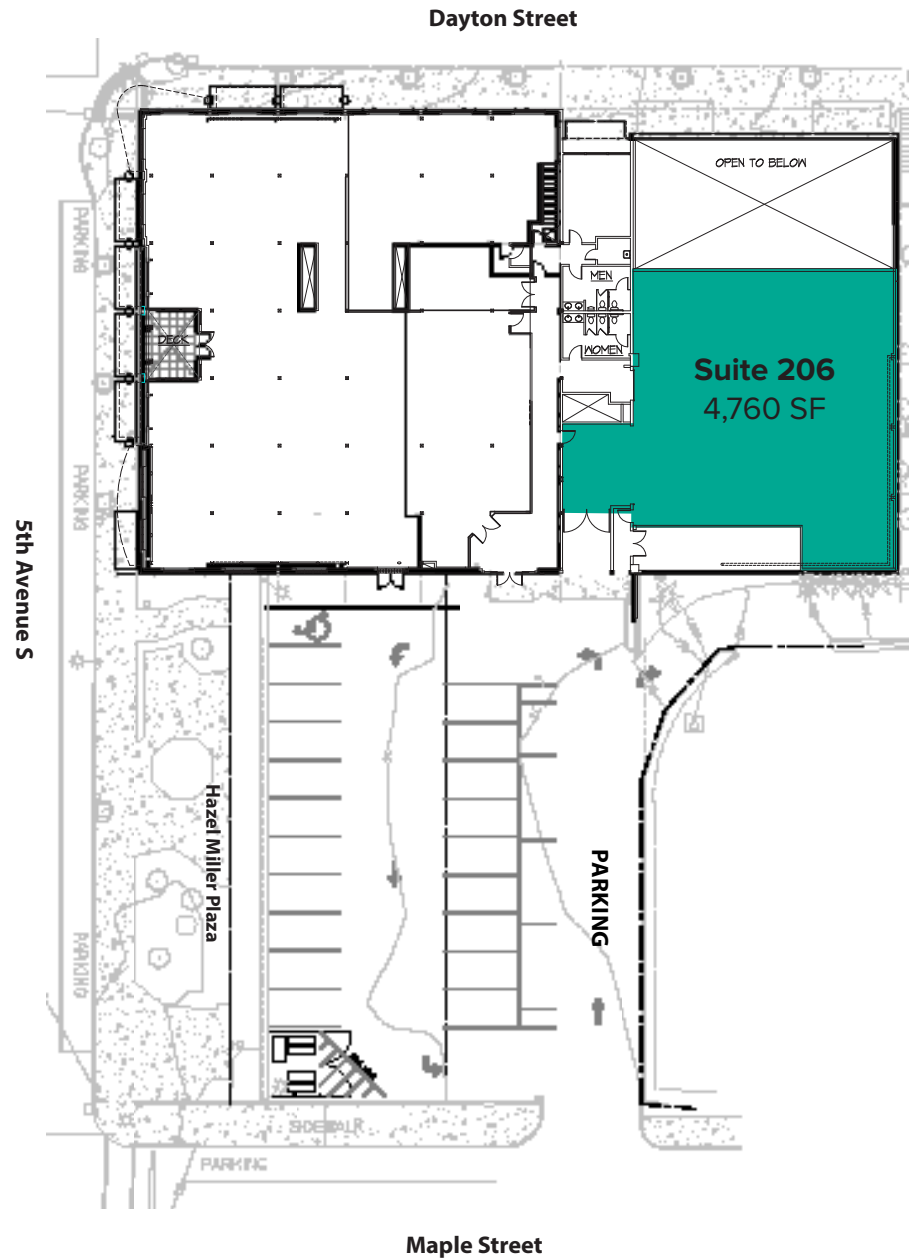

LOCATION MAP

