

OFFICE/RETAIL
LEASE



CEDAR PLAZA, Building B & D

3630 - 3680 S Cedar Street, Tacoma, WA 98409

Jack Rosen

425.289.2220

jack@rosenharbottle.com

425.454.3030
rosenharbottle.com

PO Box 5003
Bellevue, WA 98009 - 5003



OFFICE/RETAIL SPACES NEAR TACOMA MALL

834 SF - 1,800 SF Available

\$19.00 - \$23.00/SF, Gross

PROPERTY DETAILS:

- Minutes from Tacoma Mall and retail/restaurant amenities
- Neighboring anchor retailers include: Ross, Guitar Center, Michael's, McDonald's, Costco, and more
- Ample parking
- Quick access to I-5 and Highway-16
- Pylon signage available

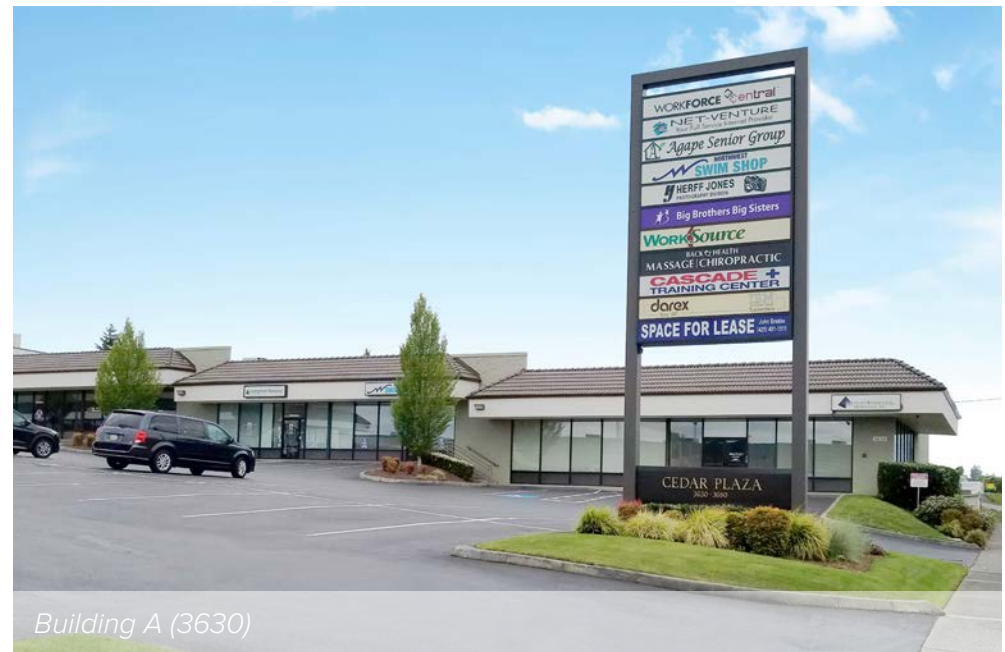

The information provided herein has been obtained from sources believed to be reliable, but no representation or warranty, express or implied, is made with respect to the accuracy or completeness of any such information. Each prospective buyer or tenant should independently investigate, evaluate and verify all information provided herein and any other matters deemed material. Please consult your attorney, tax advisor or other professional advisor. The terms of sale or lease set forth herein are subject to change or withdrawal at any time and without notice.

BUILDING B (3680)

SUITE E FEATURES

- Office/Retail Space
- Available Now
- 1,800 SF
- \$23.00/SF, Gross
- Open work area
- Back room
- 1 restroom

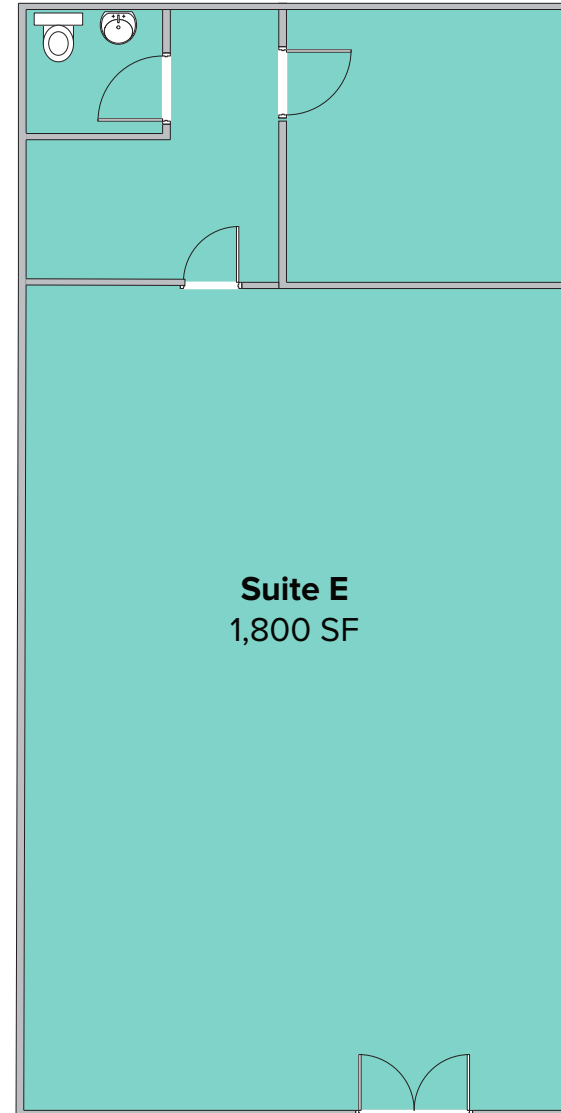

BUILDING D (3640)

SUITE W FEATURES

- Office/Retail Space
- Available Now
- 834 SF
- \$18.00/SF, Gross
- Open work area
- 1 restroom

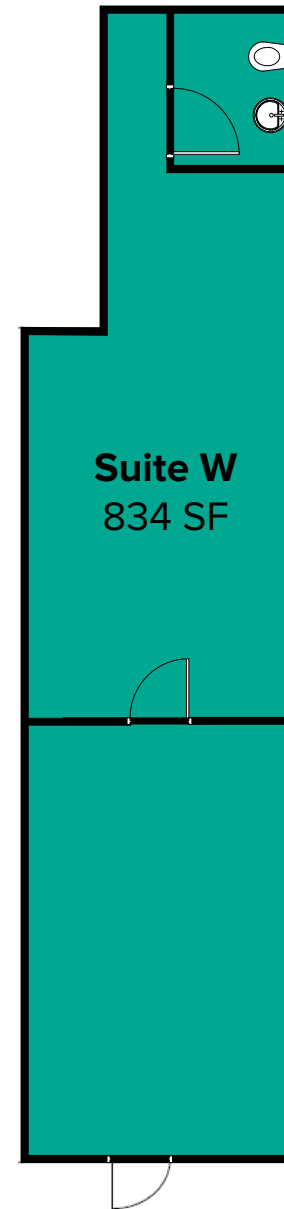

SITE PLAN



The information provided herein has been obtained from sources believed to be reliable, but no representation or warranty, express or implied, is made with respect to the accuracy or completeness of any such information. Each prospective buyer or tenant should independently investigate, evaluate and verify all information provided herein and any other matters deemed material. Please consult your attorney, tax advisor or other professional advisor. The terms of sale or lease set forth herein are subject to change or withdrawal at any time and without notice.

LOCATION MAP

