

WAREHOUSE  
LEASE



# LYNNWOOD EAST BUSINESS PARK

2031 196th Street SW | Lynnwood, WA

Caleb Farnworth, CCIM

425.289.2235

calebf@rosenharbottle.com

425.454.3030  
rosenharbottle.com

PO Box 5003  
Bellevue, WA 98009 - 5003





# WAREHOUSE/OFFICE NEAR I-5 & I-405 INTERSECTION

**6,495 SF - 7,081 SF Available**

## FEATURES:

- Professional Image
- Easy Ingress/Egress
- Abundant Parking
- Monument Signage and Building Signage Available
- Immediate Access to I-5, I-405, and SR-525

# A-101/102 & A-201 FLOOR PLAN

## FEATURES

- Available with 60 Days' Notice
- Up to 7,081 SF (2,509 - 3,144 SF ofc)
- \$7,708/Month, NNN
- 4 Private Offices
- 1 Conference Room
- Open Office Area
- Reception Area
- Break Room with Kitchenette
- 6 Restrooms
- Clear Span Warehouse
- 1 Grade-Level Door
- 1 Dock-High Door

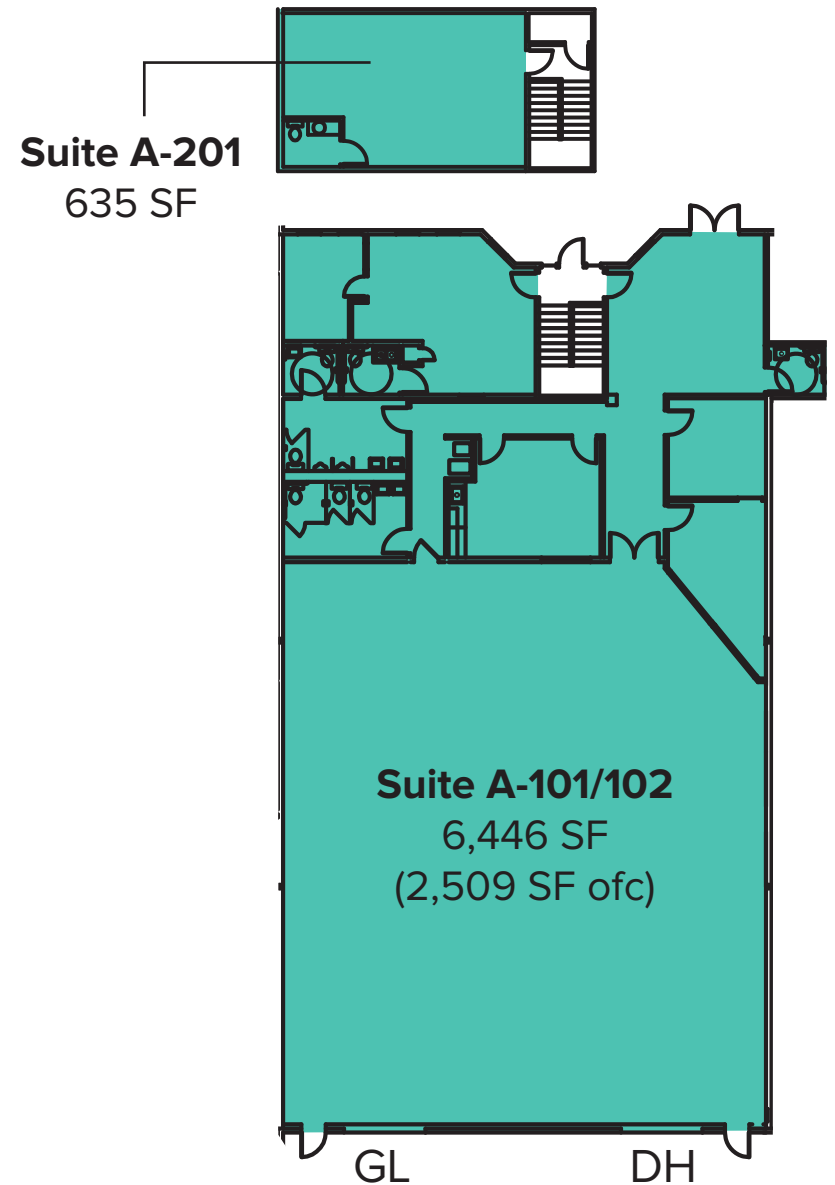

# B-105 FLOOR PLAN

## FEATURES

---

- **Available 8/1/2020**
- **6,495 SF (1,070 SF ofc)**
- **\$6,495/Month, NNN**
- 2 Private Offices
- Break Room with Kitchenette
- 2 Restrooms
- Clear Span Warehouse
- 2 Grade-Level Doors
- Potential for Fenced Yard Area

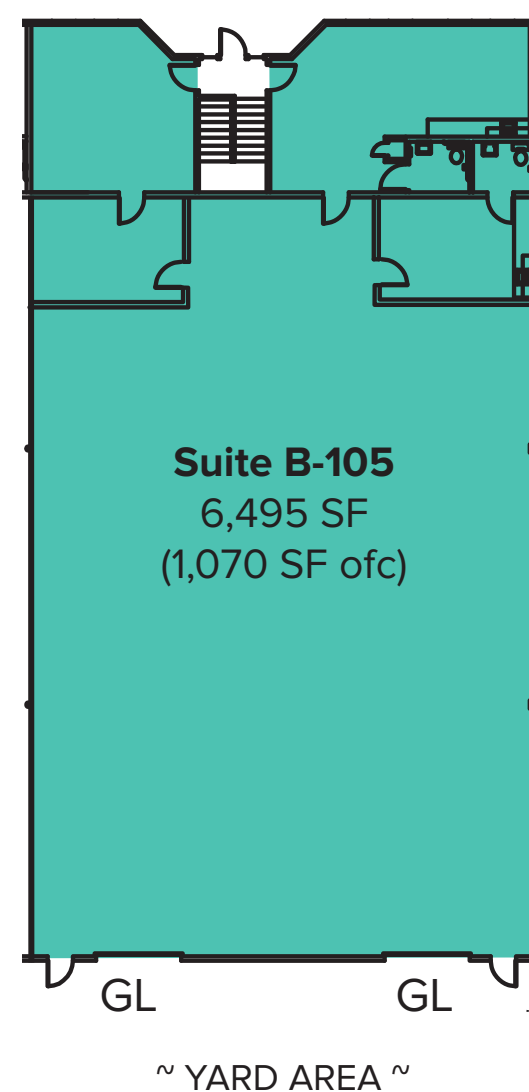

# LOCATION MAP

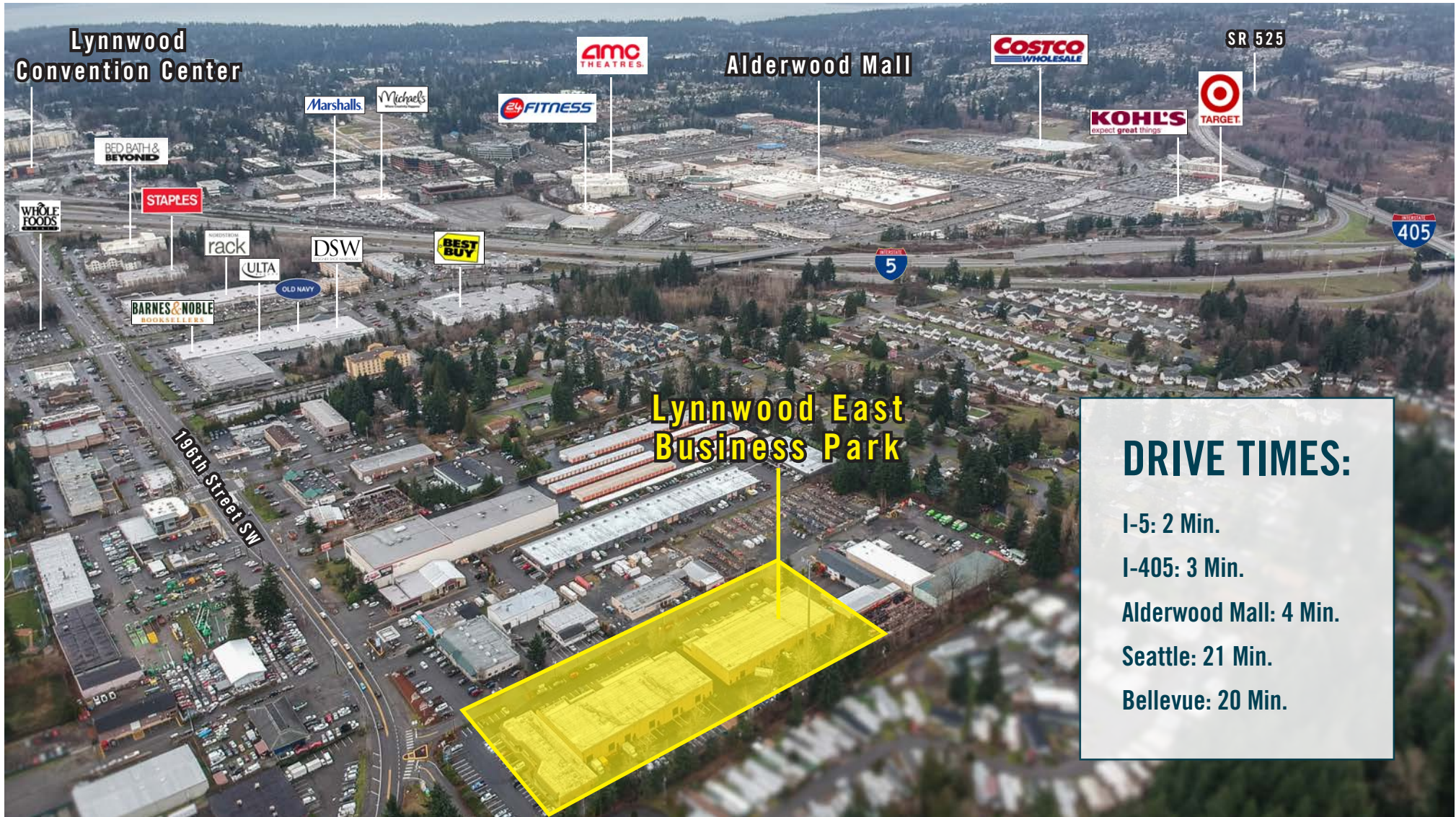

## DRIVE TIMES:

I-5: 2 Min.

I-405: 3 Min.

Alderwood Mall: 4 Min.

Seattle: 21 Min.

Bellevue: 20 Min.