

EVERGREEN INDUSTRIAL CENTER

19510 144th Avenue NE, Woodinville, WA 98072



SMALL WAREHOUSE w/ GRADE-LEVEL LOADING

Suite	Total SF	Office SF	Rent/ Month	NNN	Total/ Month	Avail
C-8	4,584 SF	0 SF	\$3,576	\$1,284	\$4,860	2/1/17

FEATURES:

- For Sublease from 2/1/2017 through 12/31/2020
- Quick Access to SR 522 & I-405
- GL Loading
- 20' - 24' Clear Height
- Sprinklered & 3-Phase Power
- 1 Restroom



For more information, contact:

**ROSEN~HARBOTTLE
COMMERCIAL REAL ESTATE**

Caleb Farnworth, CCIM
(425) 289-2235
calebf@rosenharbottle.com

www.rosenharbottle.com

Rosen~Harbottle Commercial Real Estate | P.O. Box 5003 Bellevue, WA 98009-5003
phone: (425) 454-3030 fax: (425) 454-6705 | www.rosenharbottle.com

The information provided has been obtained from sources believed reliable. While we do not doubt its accuracy, we have not verified and make no guarantee, warranty or representation about it. It is your sole responsibility to independently confirm its accuracy and completeness.

EVERGREEN INDUSTRIAL CENTER

19510 144th Avenue NE, Woodinville, WA 98072

AVAILABLE SPACE

Suite	Total SF	Ofc SF	Whse SF	Available	Suite Notes
C-8	4,584 SF	0 SF	4,584 SF	2/1/2017	Available for Sublease: 1 restroom and clear span warehouse. 1 grade-level, roll up door.

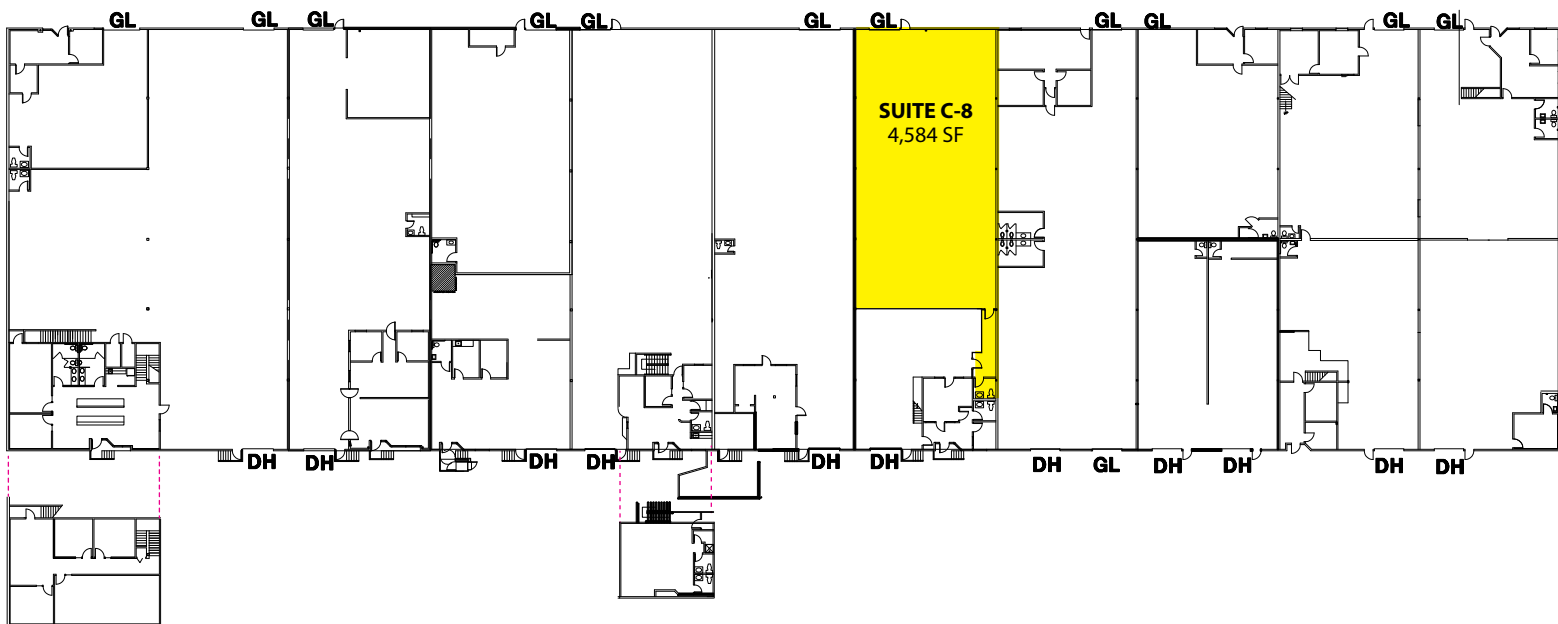

For more information, contact:

ROSEN~HARBOTTLE COMMERCIAL REAL ESTATE

Caleb Farnworth, CCIM

(425) 289-2235

calebf@rosenharbottle.com

www.rosenharbottle.com

Rosen-Harbottle Commercial Real Estate | P.O. Box 5003 Bellevue, WA 98009-5003
phone: (425) 454-3030 fax: (425) 454-6705 | www.rosenharbottle.com

The information provided has been obtained from sources believed reliable. While we do not doubt its accuracy, we have not verified and make no guarantee, warranty or representation about it. It is your sole responsibility to independently confirm its accuracy and completeness.

EVERGREEN INDUSTRIAL CENTER

19510 144th Avenue NE, Woodinville, WA 98072

WOODINVILLE WINE DISTRICT



Evergreen Industrial Center



- | | | | | |
|----------------------|------------------------------|------------------------------|-----------------------------|-----------------------|
| 1. Baer Winery | 9. Efeste | 17. Welcome Road Winery | 25. Chateau Rollat Winery | 33. Covington Cellars |
| 2. Pondera Winery | 10. Matthews Estate | 18. Gard Vintners | 26. Force Majeure Vineyards | 34. Barons Winery |
| 3. Sparkman Cellars | 11. Flying Dreams Winery | 19. Sol Stone Winery | 27. Auclair Winery | 35. Stevens Winery |
| 4. Kestrel Vintners | 12. Robert Ramsay Cellars | 20. Avennia Winery | 28. Aspenwood Cellars | 36. Hestia Cellars |
| 5. Gorman Winery | 13. Cullin Hills Winery | 21. Pacific Distillery | 29. JP Trodden Distilling | 37. Pomum Cellars |
| 6. Warr-King Wines | 14. Refuge & Prospect Winery | 22. Kevin White Winery | 30. DiStefano Winery | |
| 7. Patterson Cellars | 15. Vessel | 23. Convergence Zone Cellars | 31. Sheridan Vineyard | |
| 8. Alta Cellars | 16. Armstrong Family Winery | 24. Finn Hill Winery | 32. Two Vintners | |

Rosen-Harbottle Commercial Real Estate | P.O. Box 5003 Bellevue, WA 98009-5003
phone: (425) 454-3030 fax: (425) 454-6705 | www.rosenharbottle.com

The information provided has been obtained from sources believed reliable. While we do not doubt its accuracy, we have not verified and make no guarantee, warranty or representation about it. It is your sole responsibility to independently confirm its accuracy and completeness.