

WHSE/OFC  
LEASE



## WILLOWS PARK I & II, Building A & C

15205 - 15265 NE 95th Street | Redmond, WA 98052

Grant Rubenstein

425.289.2220

grant@rosenharbottle.com

425.454.3030  
rosenharbottle.com

PO Box 5003  
Bellevue, WA 98009 - 5003







*Building C*



*Building A*

## OFFICE / WAREHOUSE SPACES AVAILABLE

**\$1.90/SF Ofc | \$0.90/SF Whse, NNN**

**Building A: 4,461 SF (747 SF ofc)**

**Building C: 25,016 SF (13,061 SF ofc)**

### BUILDING DETAILS:

- 16' - 18' Clear Height
- Grade-Level Loading Doors
- Quality Concrete Tilt-Up Construction
- Building Signage Available
- Close-In Redmond Location

# SITE PLAN

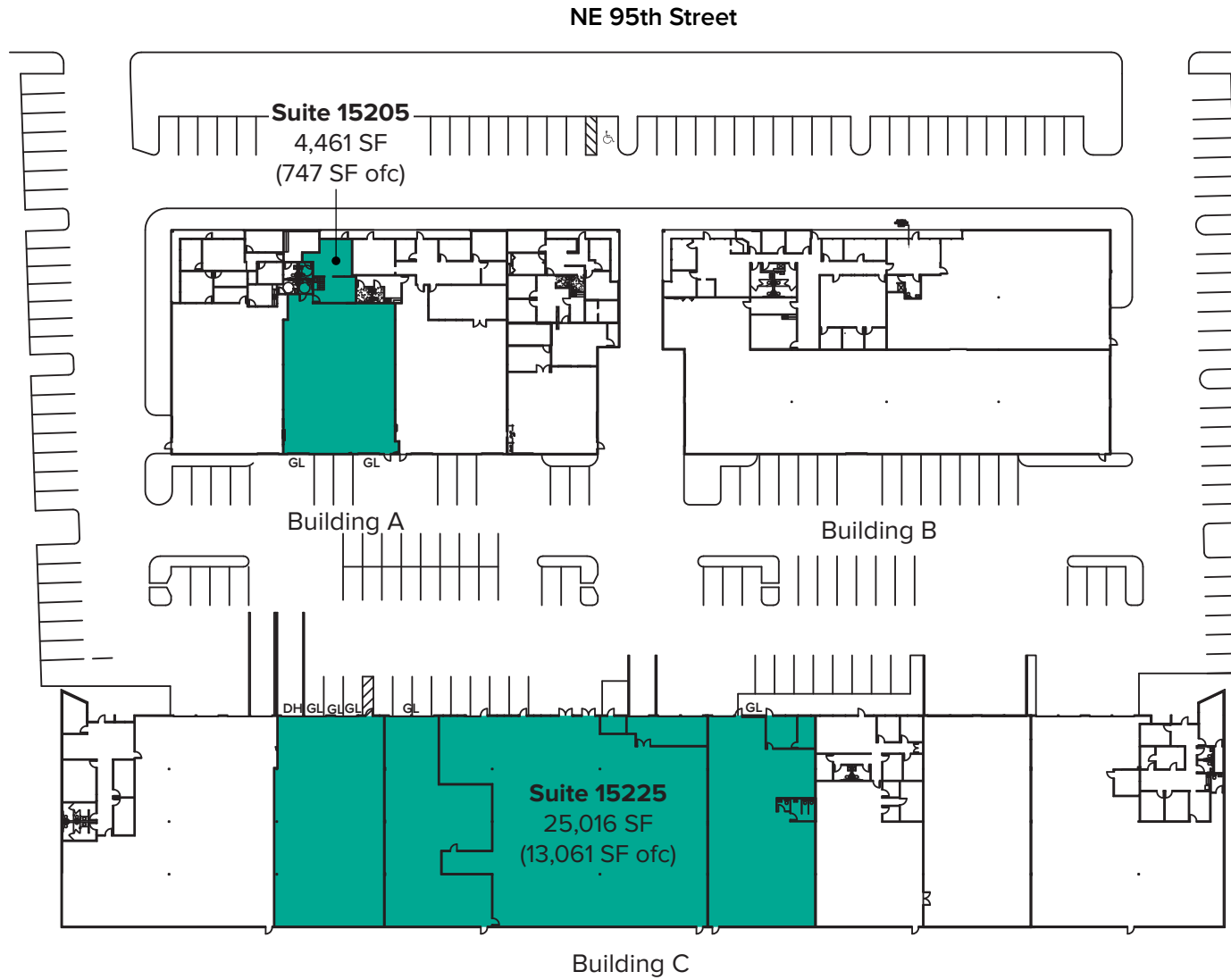

# SUITE 15205 FLOOR PLAN

Total SF	Warehouse Rate	Office Rate	Available
4,461 SF	\$0.90/SF, NNN	\$1.90/SF, NNN	1/1/2021

Notes: Warehouse/Office Space Located in Building A. 2 Restrooms. 2 Grade-Level Doors.

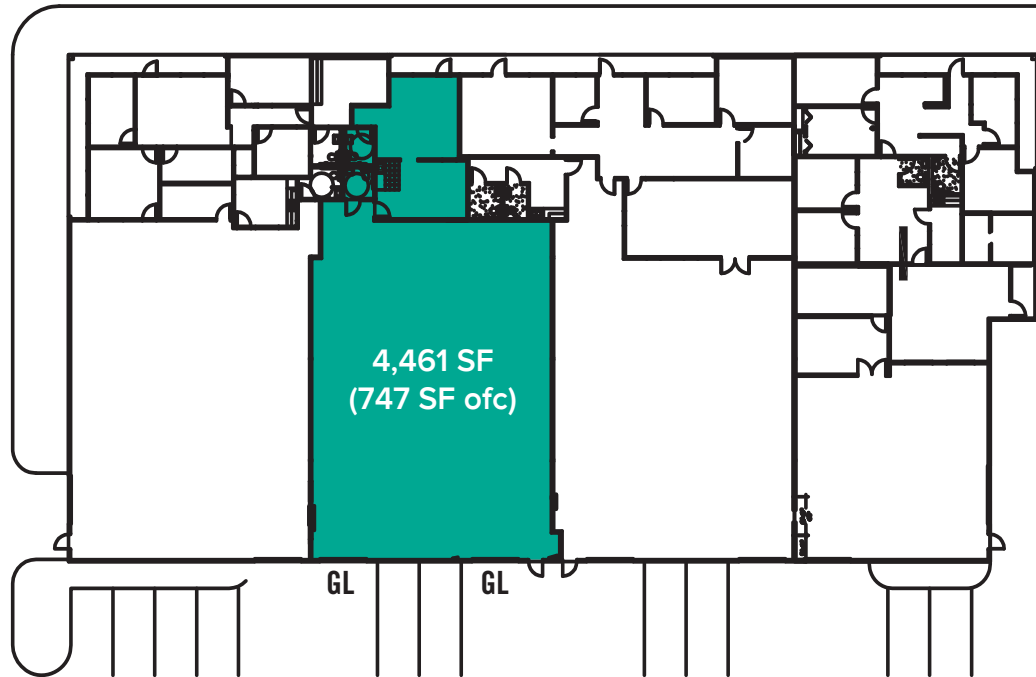

# SUITE 15225 FLOOR PLAN

Total SF	Warehouse Rate	Office Rate	Available
25,016 SF	\$0.90/SF, NNN	\$1.90/SF, NNN	12/1/2020

Notes: Large Warehouse/Office Space Located in Building C. 5 Grade-Level Doors. 1 Dock-High Loading.

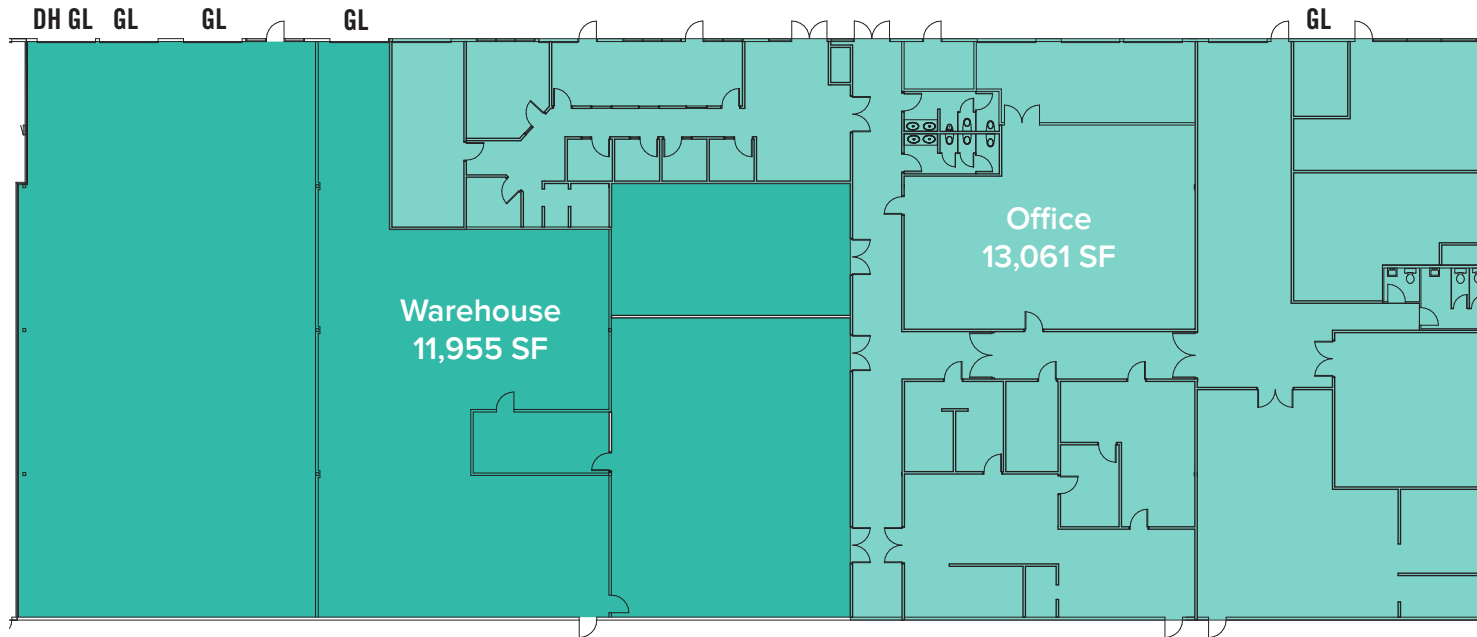



# LOCATION MAP

