

OFFICE/RETAIL  
LEASE



# **CEDAR PLAZA, Building D**

**3640 S Cedar Street, Tacoma, WA 98409**

**Jack Rosen**  
425.289.2221  
jack@rosenharbottle.com

425.454.3030  
rosenharbottle.com

PO Box 5003  
Bellevue, WA 98009 - 5003



# OFFICE/RETAIL SPACE NEAR TACOMA MALL

834 SF Available

\$19.00/SF, Gross

## PROPERTY DETAILS:

- Minutes from Tacoma Mall and retail/restaurant amenities
- Neighboring anchor retailers include: Ross, Guitar Center, Michael's, McDonald's, Costco, and more
- Ample parking
- Quick access to I-5 and Highway-16
- Pylon signage available



Building D - Lower Level (3635)

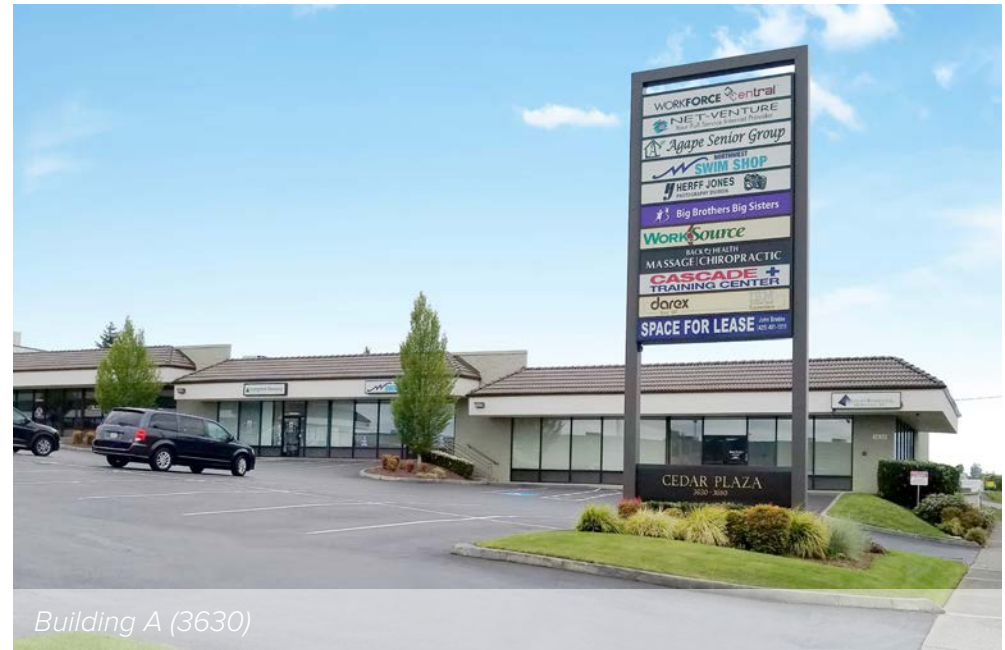

Building A (3630)

The information provided herein has been obtained from sources believed to be reliable, but no representation or warranty, express or implied, is made with respect to the accuracy or completeness of any such information. Each prospective buyer or tenant should independently investigate, evaluate and verify all information provided herein and any other matters deemed material. Please consult your attorney, tax advisor or other professional advisor. The terms of sale or lease set forth herein are subject to change or withdrawal at any time and without notice.

# BUILDING D (3640) TOP LEVEL FLOOR PLAN

## SUITE W FEATURES

---

- Office/Retail Space
- Available Now
- 834 SF
- \$19.00/SF, Gross
- Open work area
- 1 restroom

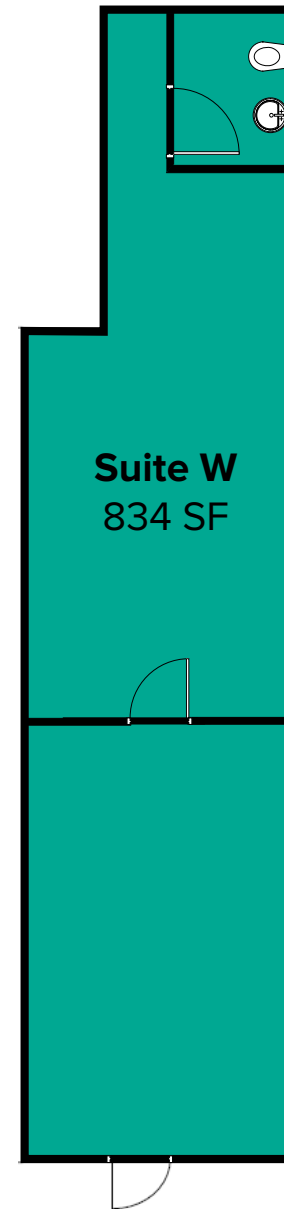



# SITE PLAN



The information provided herein has been obtained from sources believed to be reliable, but no representation or warranty, express or implied, is made with respect to the accuracy or completeness of any such information. Each prospective buyer or tenant should independently investigate, evaluate and verify all information provided herein and any other matters deemed material. Please consult your attorney, tax advisor or other professional advisor. The terms of sale or lease set forth herein are subject to change or withdrawal at any time and without notice.



# LOCATION MAP

