



**HIGH-VISIBILITY RETAIL ON
NE 20th Street**



COLUMBIA PLAZA BUILDING A

13433 NE 20th Street, Bellevue, WA 98005

Caleb Farnworth, CCIM

425.289.2235

calebf@rosenharbottle.com

Jack Rosen

425.289.2221

jack@rosenharbottle.com

Brian Stewart

425.289.2222

brians@rosenharbottle.com

425.454.3030
rosenharbottle.com

PO Box 5003
Bellevue, WA 98009 - 5003





Current Building

NEW BUILDING RENOVATIONS TO BE COMPLETED Q1/2021

\$34.00 - \$38.00/SF, NNN

1,250 SF - 10,500 SF

FEATURES:

- Retail signage on NE 20th Street
- Located in the heart of the Bel-Red corridor
- Quick access to SR-520 and I-405
- Close proximity to future Bel-Red Light Rail Station
- New building renovations to be completed February 2020
- 23,218+ Cars per day



New South Elevation Renovations

Daytime Population	1 Mile	2 Mile	3 Mile
2019	15,525	64,549	132,512
2024	17,398	70,363	143,684

FIRST LEVEL FLOOR PLAN

Contiguous 10,500 SF

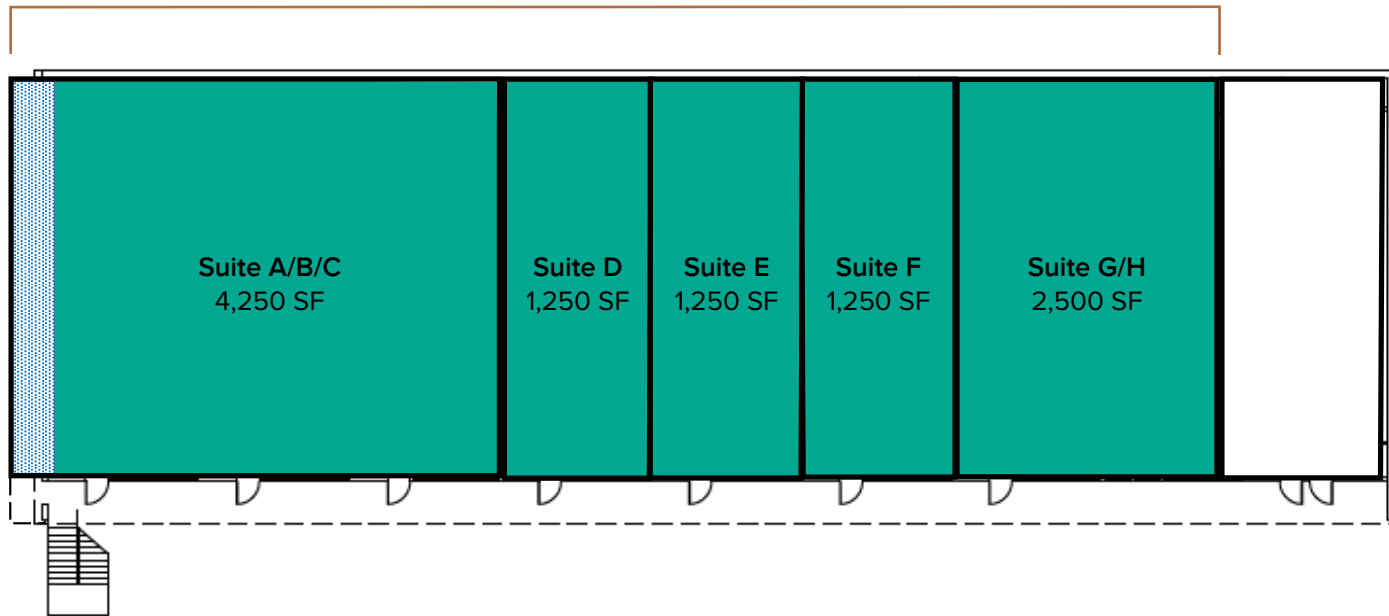

The information provided herein has been obtained from sources believed to be reliable, but no representation or warranty, express or implied, is made with respect to the accuracy or completeness of any such information. Each prospective buyer or tenant should independently investigate, evaluate and verify all information provided herein and any other matters deemed material. Please consult your attorney, tax advisor or other professional advisor. The terms of sale or lease set forth herein are subject to change or withdrawal at any time and without notice.

SECOND LEVEL FLOOR PLAN



The information provided herein has been obtained from sources believed to be reliable, but no representation or warranty, express or implied, is made with respect to the accuracy or completeness of any such information. Each prospective buyer or tenant should independently investigate, evaluate and verify all information provided herein and any other matters deemed material. Please consult your attorney, tax advisor or other professional advisor. The terms of sale or lease set forth herein are subject to change or withdrawal at any time and without notice.

LOCATION MAP

