

# FOR SUBLEASE: WAREHOUSE/OFFICE SPACE

6644 S 196th Street, Kent, WA 98032

## WAREHOUSE/OFFICE SPACE AVAILABLE AT WEST VALLEY BUSINESS PARK

**\$2.36/SF, Modified Gross**

**1,240 SF (601 SF ofc) Available**

### PROPERTY DETAILS:

- Sublease Available with 15 days' notice
- Lease expires: 5/31/28
- Office area includes 2 private office, 1 restroom, reception area, and break area with a kitchenette
- Warehouse area includes grade-level roll-up loading door
- Excellent visibility off of Highway-181
- Close proximity to I-5, I-405, and SR-167

**To Schedule a tour/Request Info, contact:**

**Stossi Tsantilas**

425.279.7943

stossit@rosenharbottle.com

**Brian Stewart**

425.289.2222

brians@rosenharbottle.com



The information provided herein has been obtained from sources believed to be reliable, but no representation or warranty, express or implied, is made with respect to the accuracy or completeness of any such information. Each prospective buyer or tenant should independently investigate, evaluate and verify all information provided herein and any other matters deemed material. Please consult your attorney, tax advisor or other professional advisor. The terms of sale or lease set forth herein are subject to change or withdrawal at any time and without notice.



# SUITE T-105 FLOOR PLAN

## SUITE FEATURES

---

- **Sublease Available with 15 days' notice**
- **Lease expires: 5/31/28**
- **1,240 SF (601 SF ofc)**
- **\$2.36/SF, Modified Gross**
- Warehouse/Office space
- Front office area includes reception,  
2 private offices, kitchenette, and 1 restroom
- 1 Grade-Level Roll-up Loading Door

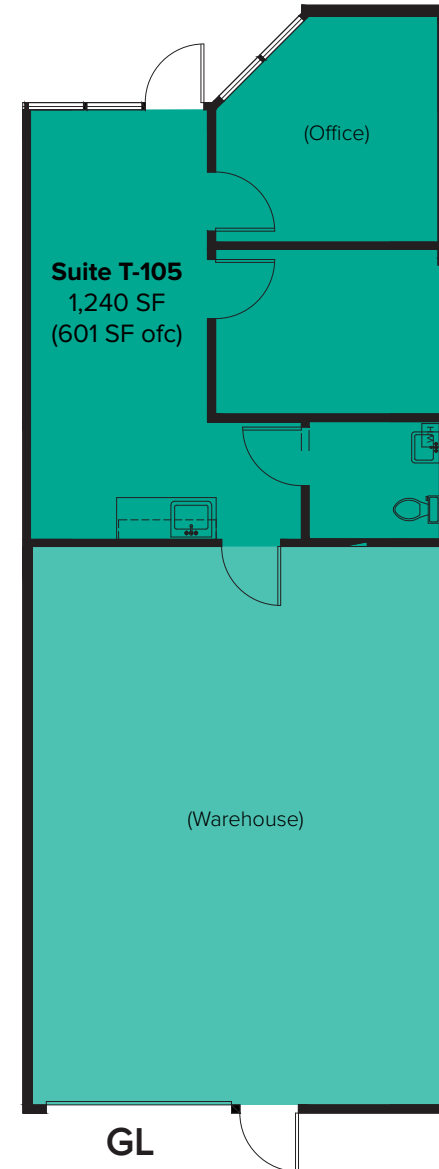

# LOCATION MAP

