



**HIGH-VISIBILITY RETAIL ON  
NE 20th Street**



# **COLUMBIA PLAZA BUILDING A**

**13433 NE 20th Street, Bellevue, WA 98005**

**Caleb Farnworth, CCIM**

425.289.2235

calebf@rosenharbottle.com

**Jack Rosen**

425.289.2221

jack@rosenharbottle.com

**Brian Stewart**

425.289.2222

brians@rosenharbottle.com

425.454.3030  
rosenharbottle.com

PO Box 5003  
Bellevue, WA 98009 - 5003





*Current Building*

# NEW BUILDING RENOVATIONS TO BE COMPLETED Q3/2021

**\$34.00 - \$38.00/SF, NNN**

**1,250 SF - 10,500 SF**

## FEATURES:

- Retail signage on NE 20th Street
- Located in the heart of the Bel-Red corridor
- Quick access to SR-520 and I-405
- Close proximity to future Bel-Red Light Rail Station
- New building renovations to be completed February 2020
- 23,218+ Cars per day



*New South Elevation Renovations*

Daytime Population	1 Mile	2 Mile	3 Mile
2019	15,525	64,549	132,512
2024	17,398	70,363	143,684

# FIRST LEVEL FLOOR PLAN

Contiguous 10,500 SF

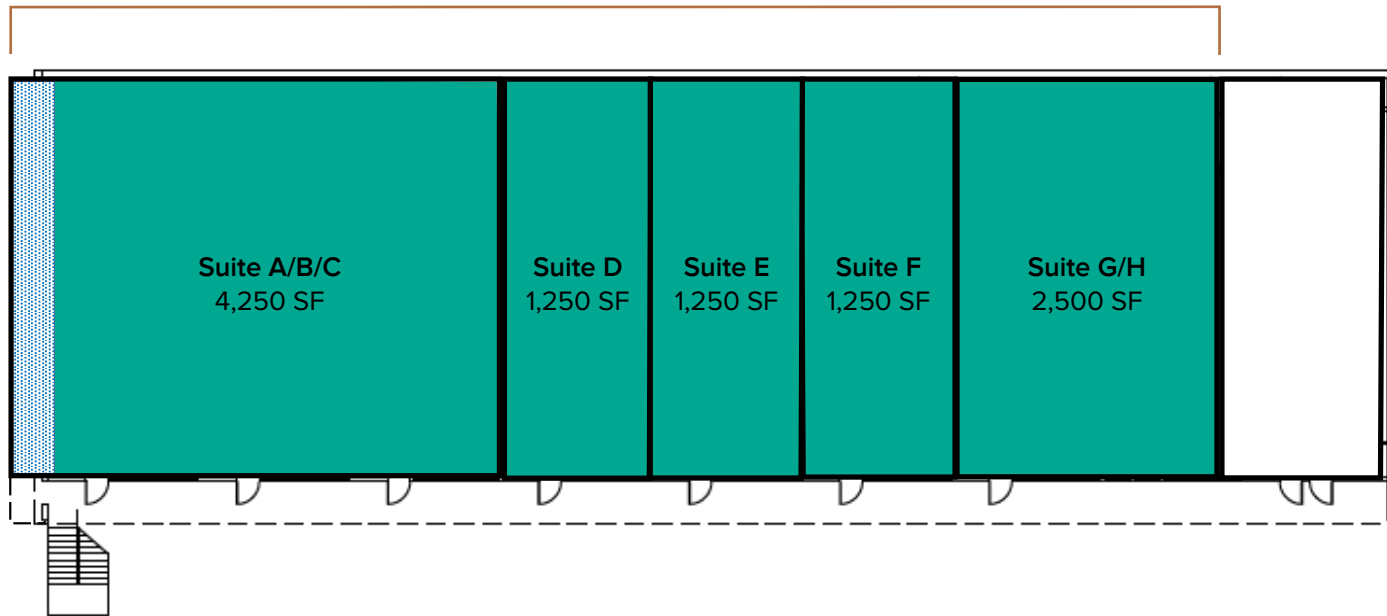

The information provided herein has been obtained from sources believed to be reliable, but no representation or warranty, express or implied, is made with respect to the accuracy or completeness of any such information. Each prospective buyer or tenant should independently investigate, evaluate and verify all information provided herein and any other matters deemed material. Please consult your attorney, tax advisor or other professional advisor. The terms of sale or lease set forth herein are subject to change or withdrawal at any time and without notice.

# SECOND LEVEL FLOOR PLAN



The information provided herein has been obtained from sources believed to be reliable, but no representation or warranty, express or implied, is made with respect to the accuracy or completeness of any such information. Each prospective buyer or tenant should independently investigate, evaluate and verify all information provided herein and any other matters deemed material. Please consult your attorney, tax advisor or other professional advisor. The terms of sale or lease set forth herein are subject to change or withdrawal at any time and without notice.



# LOCATION MAP

