

OFC/WHSE
LEASE

Available

EASTLAKE BUSINESS PARK, Building D

18336-18398 Redmond-Fall City Road | Redmond, WA 98052

Caleb Farnworth, CCIM

425.289.2235

calebf@rosenharbottle.com

425.454.3030
rosenharbottle.com

PO Box 5003
Bellevue, WA 98009 - 5003





OFFICE/WAREHOUSE SPACE AVAILABLE

\$3,296/Month, NNN

2,197 SF (392 SF ofc)

BUILDING DETAILS:

- Professional, Business Park Setting
- Quick Access to SR 520, Union Hill & Downtown Redmond
- Nearby Amenities Include Home Depot, Whole Foods, Chipotle, Target, Kohl's, Costco & More
- Located Minutes From Future Light Rail Stations

BUILDING D FLOOR PLAN

SUITE FEATURES:

- Available 10/1/2020
- 2,197 SF (392 SF ofc)
- \$3,296/Month, NNN
- 1 Private Office
- 1 Restroom
- Reception Area
- 1 GL Roll-up Loading Door
- 14' - 16' Clear Height in Warehouse

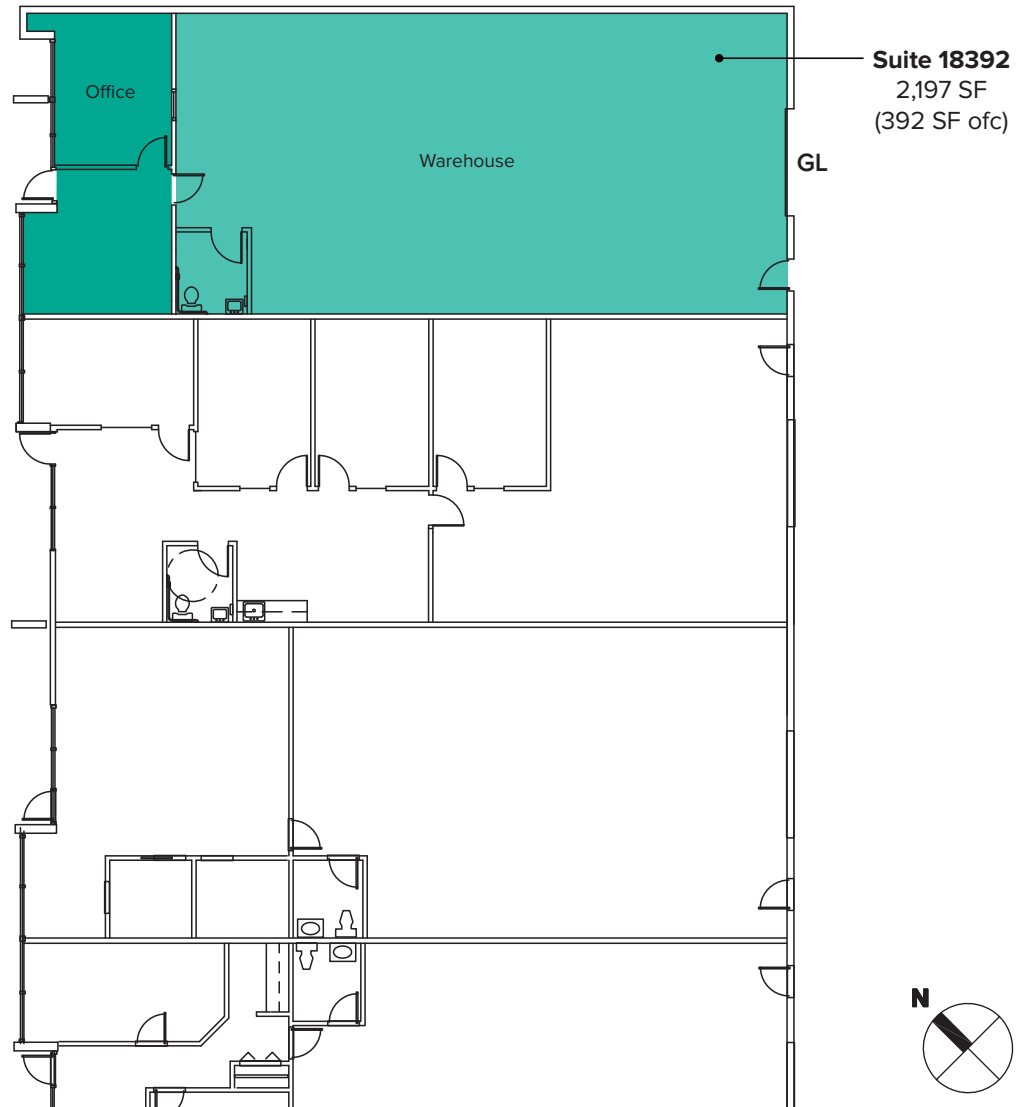

LOCATION MAP

