

# Stone Avenue Building

1330-1334 N 131st Street, Seattle, WA 98133



## RARE OFFICE/WHSE IN SEATTLE

**14,662 SF (1,527 SF ofc) Available**

**\$1.35/SF Ofc | \$0.75/SF Whse, NNN**

### FEATURES:

- 2 GL Loading Doors
- Available with 90 Days Notice
- 24' Clear Height
- Quick Access to I-5 & 1 Block from Aurora Avenue
- Across the Street from Hobby Lobby & PetSmart
- Prominent Signage Available
- Under New Ownership



For more information, contact:

**ROSEN~HARBOTTLE  
COMMERCIAL REAL ESTATE**

**Grant Rubenstein**  
(425) 289-2220  
grant@rosenharbottle.com

www.rosenharbottle.com

Rosen-Harbottle Commercial Real Estate | PO Box 5003, Bellevue, WA 98009-5003  
Phone: (425) 454-3030 Fax: (425) 454-6705 | www.rosenharbottle.com

The information provided has been obtained from sources believed reliable. While we do not doubt its accuracy, we have not verified and make no guarantee, warranty or representation about it. It is your sole responsibility to independently confirm its accuracy and completeness.

# Stone Avenue Building

1330-1334 N 131st Street, Seattle, WA 98133

## Floor Plan

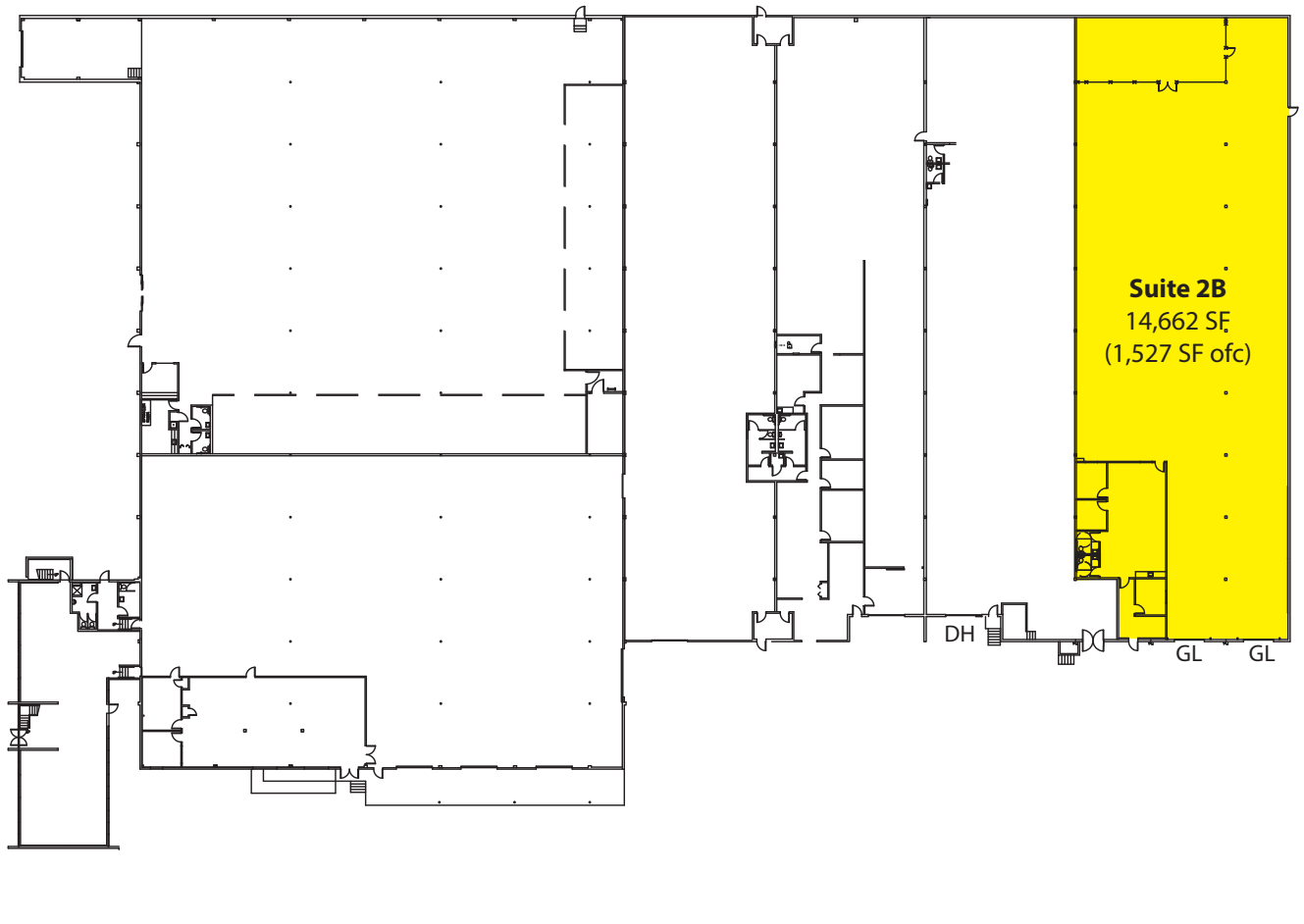

# Stone Avenue Building

1330-1334 N 131st Street, Seattle, WA 98133

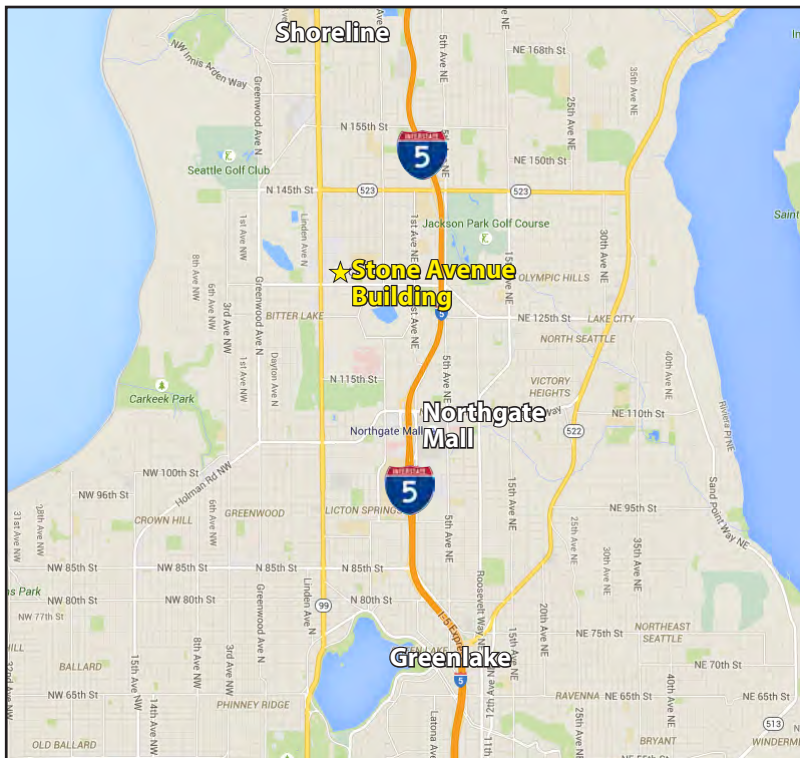
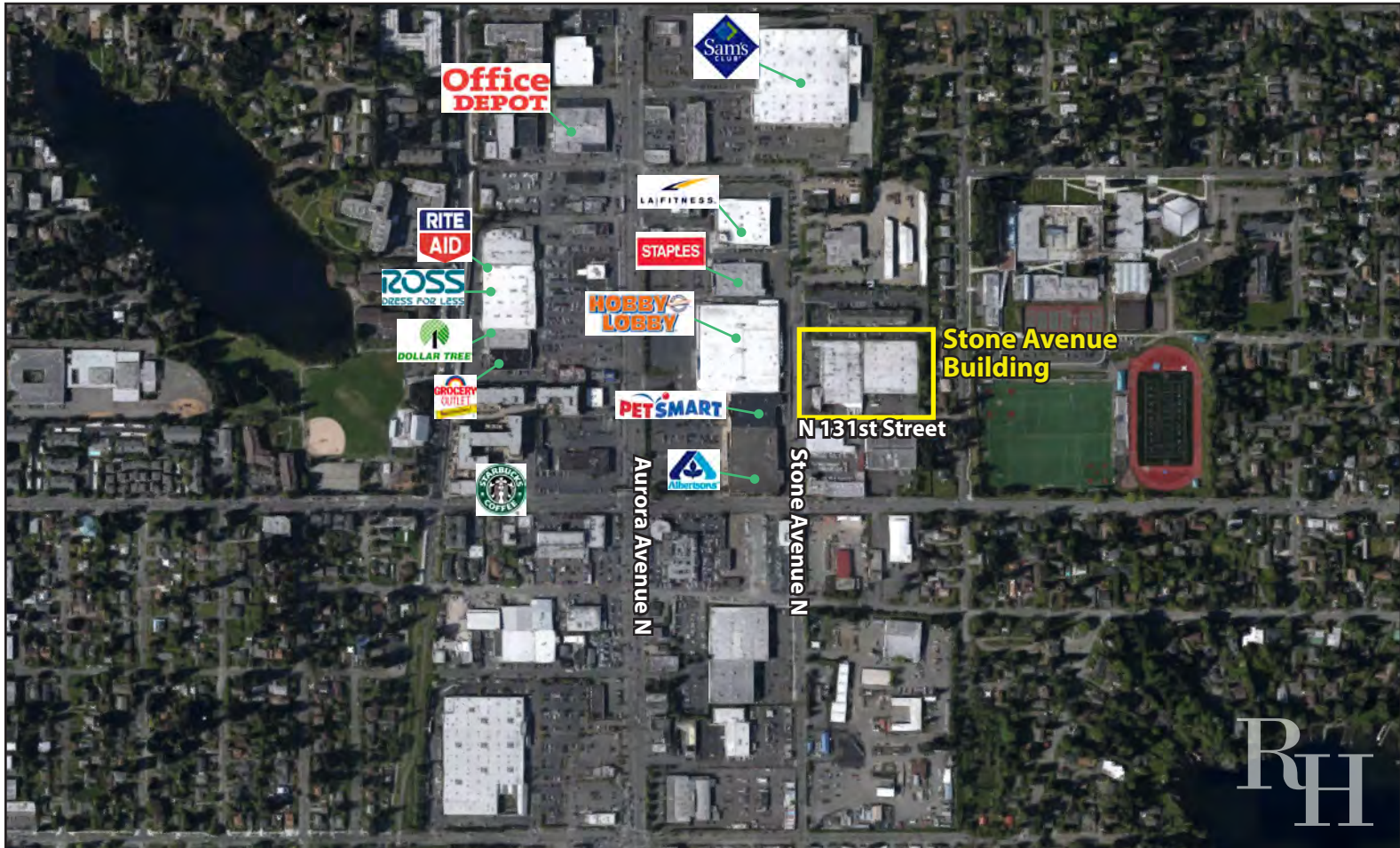

For more information, contact:

**ROSEN~HARBOTTLE  
COMMERCIAL REAL ESTATE**

**Grant Rubensein**  
(425) 289-2220  
grant@rosenharbottle.com

www.rosenharbottle.com