

NEWLY RENOVATED  
**EXTERIOR**

Your Name Here

TOC CUTS

30 LAKE SHORE PLAZA

# 107 LAKE STREET BUILDING

30 Lake Shore Plaza | Kirkland, WA

**Jack Rosen**

425.289.2221

jack@rosenharbottle.com

425.454.3030  
rosenharbottle.com

PO Box 5003  
Bellevue, WA 98009 - 5003



# DOWNTOWN KIRKLAND RETAIL LOCATION

**\$30.00/SF, NNN**

**1,044 SF - 2,734 SF Available**

## FEATURES:

- Recently renovated spaces and restrooms
- 585 SF - 743 SF Storage Space (\$600/Month)
- Direct entry and common lobby entrance
- Great foot-traffic and exposure
- Space faces Lake Washington
- Public parking lot in front



The information provided herein has been obtained from sources believed to be reliable, but no representation or warranty, express or implied, is made with respect to the accuracy or completeness of any such information. Each prospective buyer or tenant should independently investigate, evaluate and verify all information provided herein and any other matters deemed material. Please consult your attorney, tax advisor or other professional advisor. The terms of sale or lease set forth herein are subject to change or withdrawal at any time and without notice.

# FLOOR PLAN

Suite	Square Feet	Rate	Notes
102	1,044 SF	\$30.00/SF, NNN	Retail/Office space with lobby entrance. Suite includes storage space (\$600/Month) for a total of 1,629 SF. <b>Available now.</b>
104	1,991 SF	\$30.00/SF, NNN	Retail space with direct entry and lobby entrance. Suite includes storage space (\$600/Month) for a total of 2,734 SF. <b>Available now.</b>

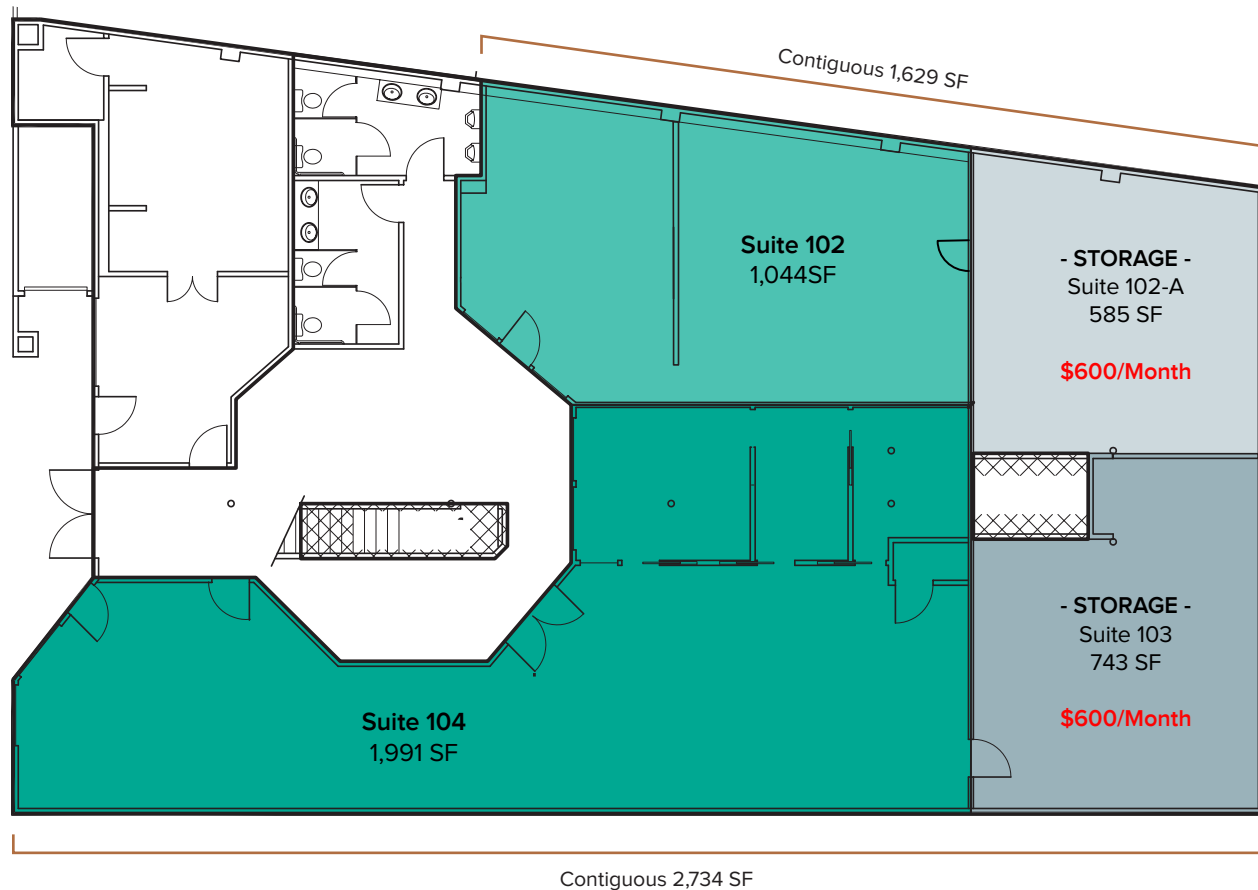

The information provided herein has been obtained from sources believed to be reliable, but no representation or warranty, express or implied, is made with respect to the accuracy or completeness of any such information. Each prospective buyer or tenant should independently investigate, evaluate and verify all information provided herein and any other matters deemed material. Please consult your attorney, tax advisor or other professional advisor. The terms of sale or lease set forth herein are subject to change or withdrawal at any time and without notice.



# LOCATION MAP

