



**SMALL OFC/WHSE  
LEASE**

Highway 167 - 93,855 CPD

## **KENT BUSINESS CENTER, BUILDING A & B**

**25316 - 25530 74th Avenue S | Kent, WA**

**Brian Stewart**

425.289.2222

brians@rosenharbottle.com

**Grant Rubenstein**

425.289.2220

grant@rosenharbottle.com

425.454.3030  
rosenharbottle.com

PO Box 5003  
Bellevue, WA 98009 - 5003







# HIGH-IMAGE OFFICE/WHSE/ FLEX SPACES AVAILABLE

1,644 SF - 7,641 SF

## LOCATION FEATURES:

- Varying Suite Sizes - Ready to Lease
- Grade-Level Loading Doors
- Direct Entry to Suites
- Quick Access to State Route 167, SR 516 & Downtown
- Close-by Kent Station, Retail and Restaurant Amenities



The information provided herein has been obtained from sources believed to be reliable, but no representation or warranty, express or implied, is made with respect to the accuracy or completeness of any such information. Each prospective buyer or tenant should independently investigate, evaluate and verify all information provided herein and any other matters deemed material. Please consult your attorney, tax advisor or other professional advisor. The terms of sale or lease set forth herein are subject to change or withdrawal at any time and without notice.

# BUILDING A FLOOR PLAN

Suite	Square Feet	Rate	Notes
25408	2,398 SF	Call Agents	Open office space with 3 entrance doors, 2 POs, 2 restrooms, and kitchenette. <b>Available now.</b>
25500	7,641 SF (3,778 SF ofc)	Call Agents	Office/Warehouse space with 7 POs, 2 restrooms, break area with kitchenette, open warehouse area, and 3 GL roll-up doors. <b>Available 5/1/2021.</b>

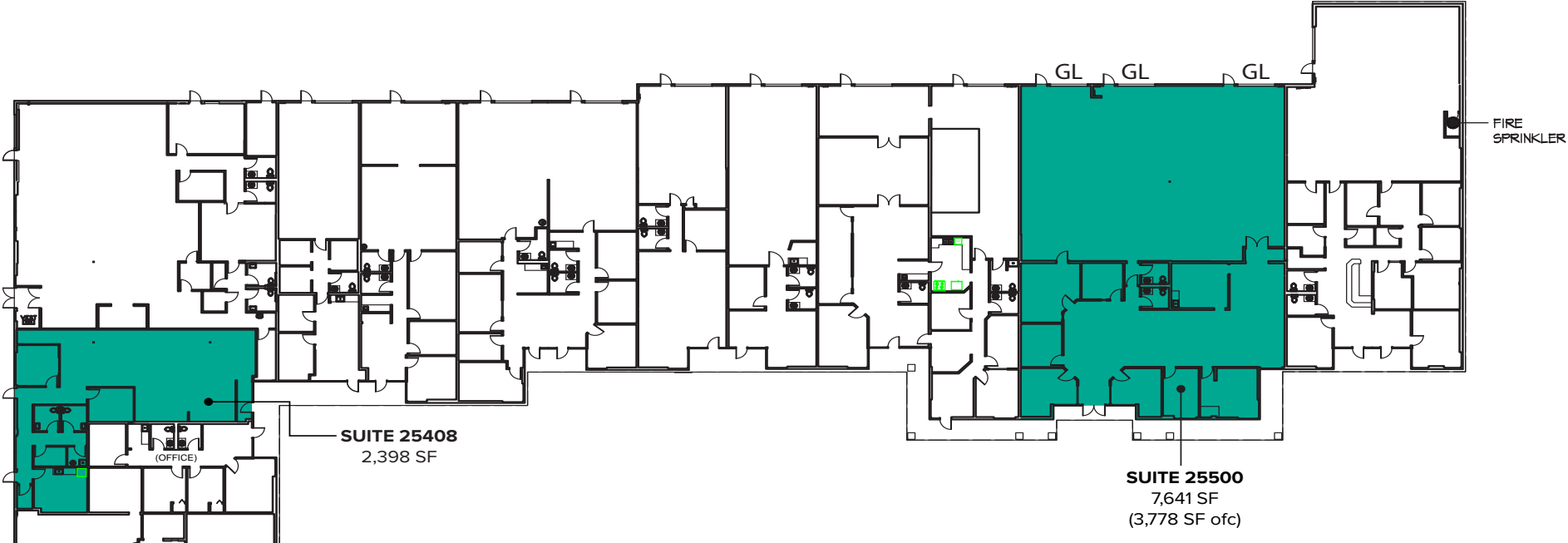

The information provided herein has been obtained from sources believed to be reliable, but no representation or warranty, express or implied, is made with respect to the accuracy or completeness of any such information. Each prospective buyer or tenant should independently investigate, evaluate and verify all information provided herein and any other matters deemed material. Please consult your attorney, tax advisor or other professional advisor. The terms of sale or lease set forth herein are subject to change or withdrawal at any time and without notice.

# BUILDING B FLOOR PLAN

Suite	Square Feet	Rent	Notes
25520	1,644 SF (652 SF ofc)	Call Agents	Office/warehouse with 1 PO, 1 restroom, and 1 GL roll-up door. Contiguous with Suite 25522 for a total of 3,305 SF (1,380 SF ofc). <b>Available 7/1/21.</b>
25522	1,661 SF (728 SF ofc)	Call Agents	Office/warehouse with 3 POs, 1 restroom, break area with kitchenette, and 1 GL roll-up door. Contiguous with Suite 25520 for a total of 3,305 SF (1,380 SF ofc). <b>Available with 30 days' notice.</b>



The information provided herein has been obtained from sources believed to be reliable, but no representation or warranty, express or implied, is made with respect to the accuracy or completeness of any such information. Each prospective buyer or tenant should independently investigate, evaluate and verify all information provided herein and any other matters deemed material. Please consult your attorney, tax advisor or other professional advisor. The terms of sale or lease set forth herein are subject to change or withdrawal at any time and without notice.



# LOCATION MAP

