

An aerial photograph of Eastlake Business Park in Redmond, WA. The image shows several large, white, single-story industrial buildings with flat roofs and multiple garage doors. Building B is highlighted with a green border and the word "Available" written in green. The park is surrounded by lush green trees and a paved road labeled "Redmond-Fall City Road NE" runs along the bottom right. A teal banner in the top right corner contains the text "INDUSTRIAL LEASE".

**INDUSTRIAL  
LEASE**

## **EASTLAKE BUSINESS PARK, Building B**

**18336-18398 Redmond-Fall City Road | Redmond, WA 98052**

**Caleb Farnworth, CCIM**

425.289.2235

calebf@rosenharbottle.com

425.454.3030  
rosenharbottle.com

PO Box 5003  
Bellevue, WA 98009 - 5003





# EASTSIDE INDUSTRIAL SPACE WITH OFFICE

**1,376 SF Available**

**\$1.50/SF, NNN**

## PROPERTY DETAILS:

- Professional, Business Park Setting
- Quick Access to SR 520, Union Hill & Downtown Redmond
- Nearby Amenities Include Home Depot, Whole Foods, Chipotle, Target, Kohl's, Costco & More
- Located Minutes From Future Light Rail Stations

The information provided herein has been obtained from sources believed to be reliable, but no representation or warranty, express or implied, is made with respect to the accuracy or completeness of any such information. Each prospective buyer or tenant should independently investigate, evaluate and verify all information provided herein and any other matters deemed material. Please consult your attorney, tax advisor or other professional advisor. The terms of sale or lease set forth herein are subject to change or withdrawal at any time and without notice.



# BUILDING B FLOOR PLAN

## SUITE 18336 FEATURES

- Available 8/1/2022
- 1,376 SF (738 SF ofc)
- \$1.50/SF, NNN
- Industrial space
- Front office area
- 2 Private rooms located in office area
- 1 Restroom
- 1 Grade-Level Roll-up Loading Door
- 14' - 16' Clear Height in Warehouse

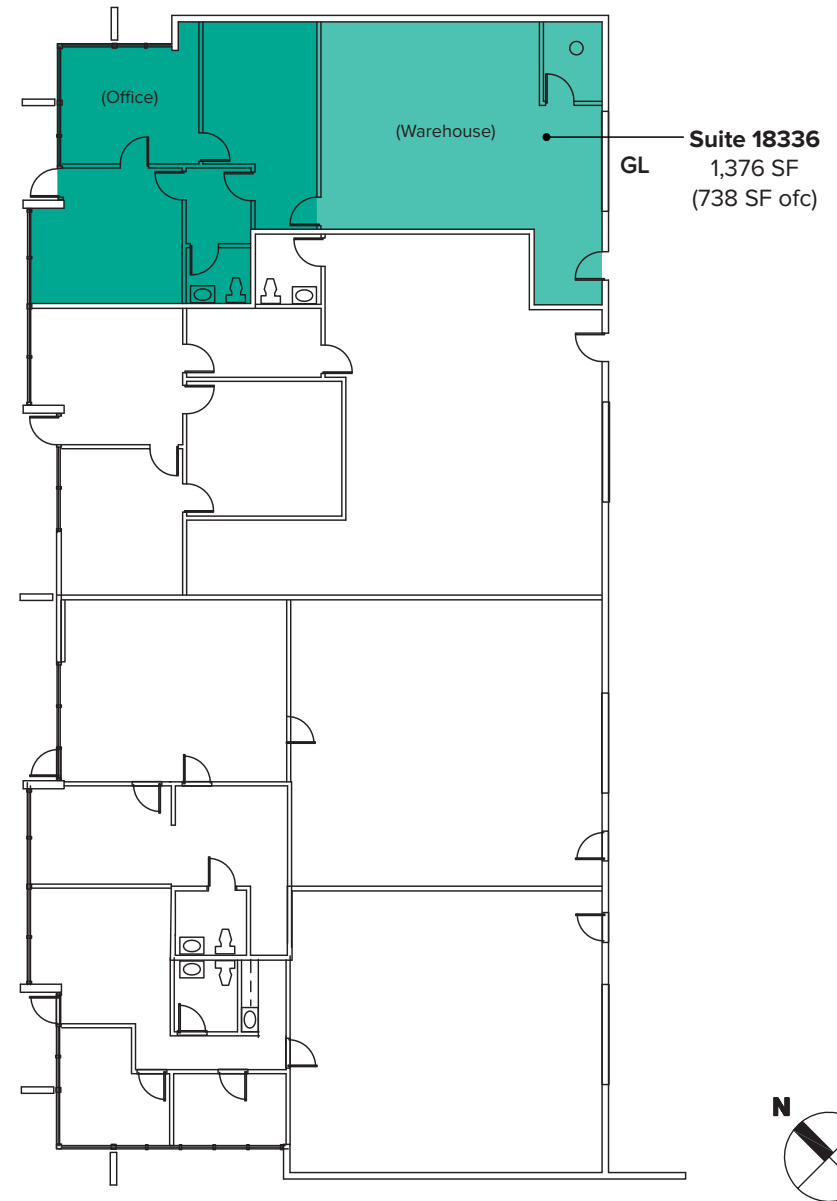

# LOCATION MAP

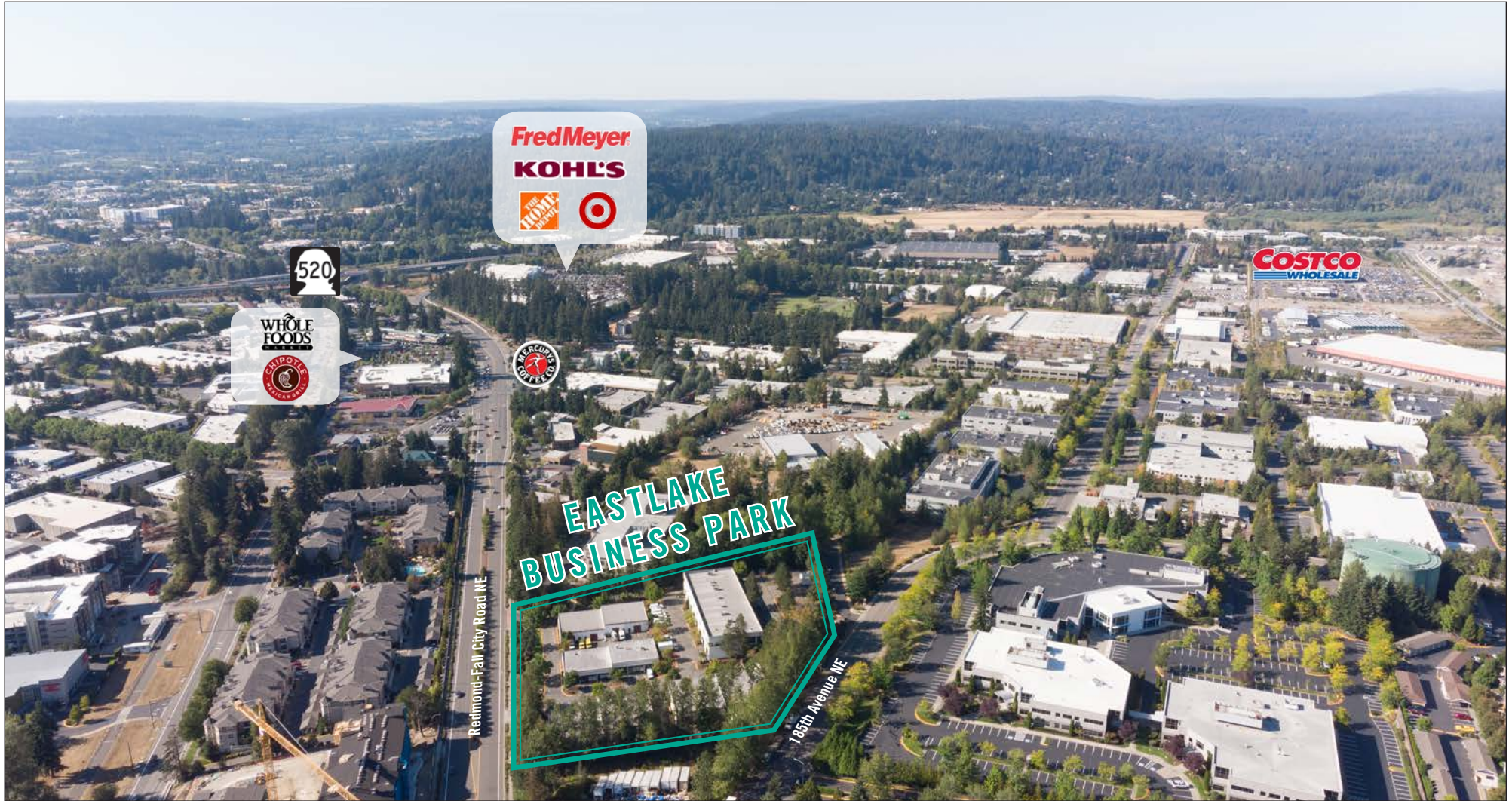

# LOCATION MAP

