

WHSE/OFC
LEASE



WILLOWS PARK I & II, Building C

15205 - 15265 NE 95th Street | Redmond, WA 98052

Grant Rubenstein

425.289.2220

grant@rosenharbottle.com

425.454.3030
rosenharbottle.com

PO Box 5003
Bellevue, WA 98009 - 5003





LARGE OFFICE/WAREHOUSE SPACE AVAILABLE

\$1.90/SF Ofc | \$0.90/SF Whse, NNN

5,000 SF - 25,016 SF Available

BUILDING DETAILS:

- 18' Clear Height
- Grade-Level Loading Doors
- Dock-High Loading Doors
- Quality Concrete Tilt-Up Construction
- Building Signage Available
- Close-In Redmond Location

SUITE 15225 FLOOR PLAN

Features

- Available 12/1/2020
- 5,000 SF - 25,016 SF (2,709 SF ofc)
- Office Rate: \$1.90/SF, NNN
- Warehouse Rate: \$0.90/SF, NNN
- Warehouse/Office Space
- Located In Building C
- Power at 4,400 amps
- 36 Tons of HVAC
- 6" Sewer Line
- 4 GL Doors
- 2 DH Doors
- 3 Restrooms

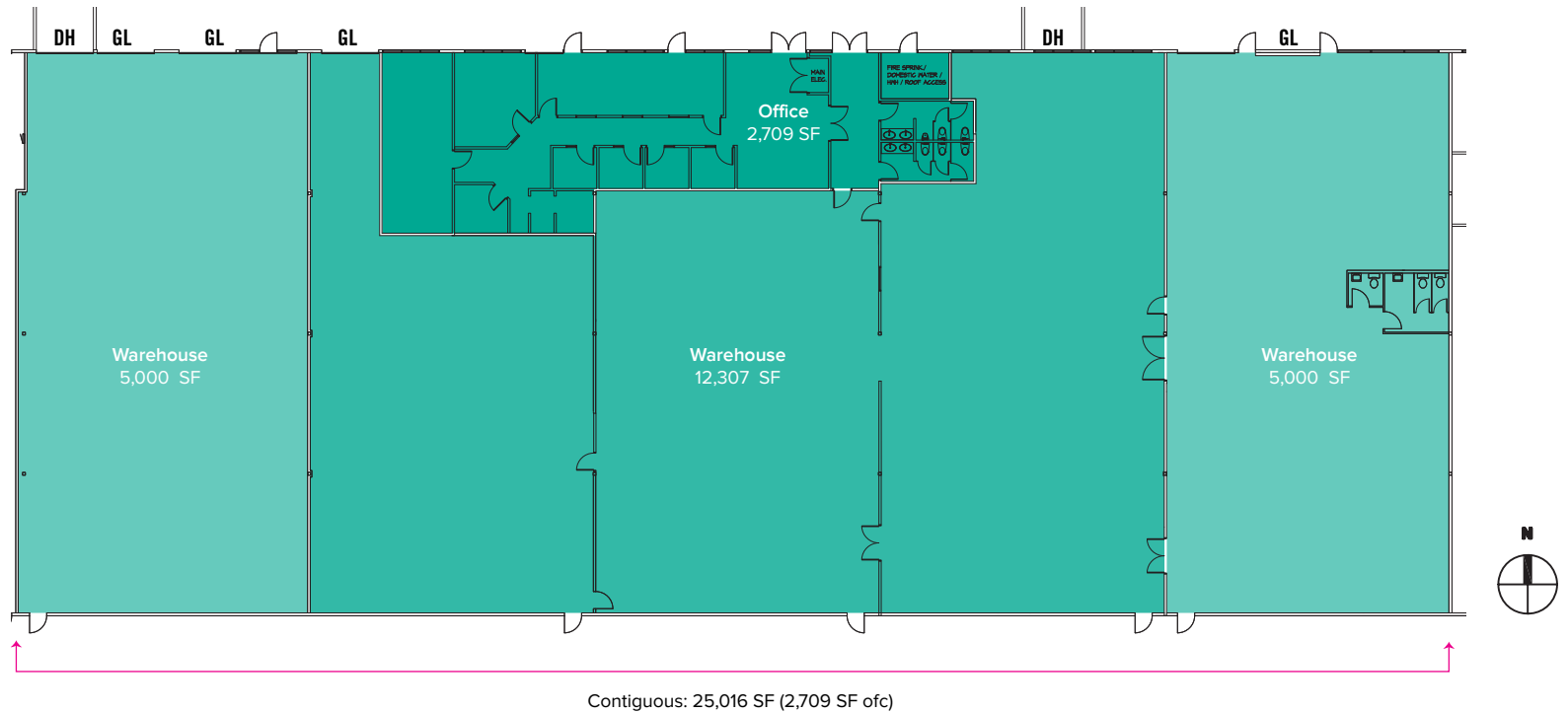

SITE PLAN

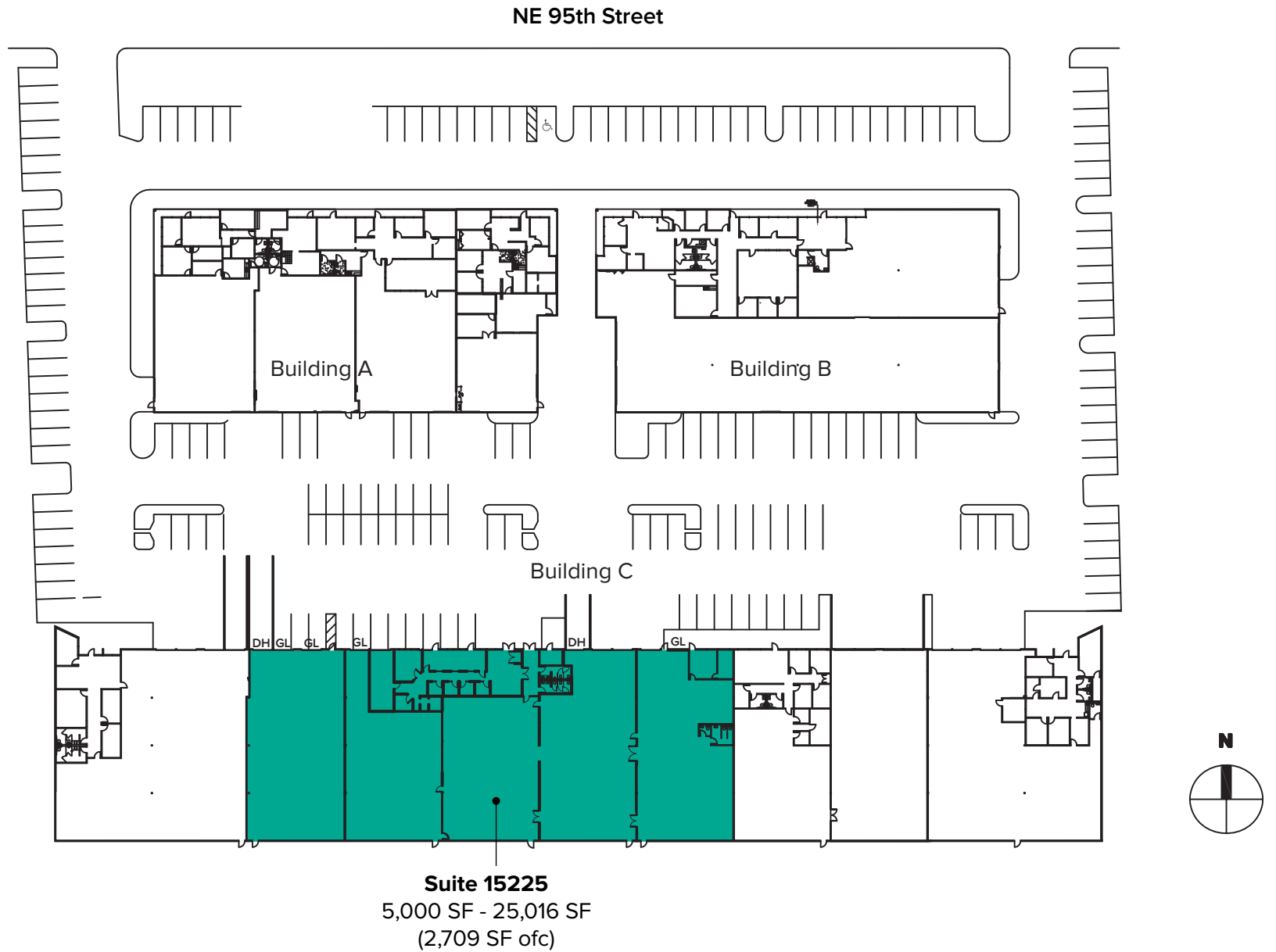

LOCATION MAP

