

OFC/IND  
LEASE



## RH NORTH CREEK BUSINESS CENTER, Building 3

11812-11824 North Creek Parkway N | Bothell, WA

**Brian Stewart**

425.289.2222

brians@rosenharbottle.com

425.454.3030  
rosenharbottle.com

**Caleb Farnworth, CCIM**

425.289.2235

calebf@rosenharbottle.com

PO Box 5003  
Bellevue, WA 98009 - 5003



# OFFICE/WAREHOUSE SPACE LOCATED IN CLASS A CORPORATE CAMPUS

**2,016 SF Available**

**\$18.50/SF, NNN**

## LOCATION FEATURES:

- On-Site Deli and Childcare
- Nearby Amenities: Restaurants, Retail Shops, Food Trucks, Corporate Marriott, Walking Trails, Sports Fields, & Fitness Center
- Quick Access to I-405, SR-522 & Downtown Bothell



The information provided herein has been obtained from sources believed to be reliable, but no representation or warranty, express or implied, is made with respect to the accuracy or completeness of any such information. Each prospective buyer or tenant should independently investigate, evaluate and verify all information provided herein and any other matters deemed material. Please consult your attorney, tax advisor or other professional advisor. The terms of sale or lease set forth herein are subject to change or withdrawal at any time and without notice.

# BUILDING 3 (11824) FLOOR PLAN

| Suite  | SF       | Rate            | Available |
|--------|----------|-----------------|-----------|
| 3-101A | 2,016 SF | \$18.50/SF, NNN | 10/1/2021 |

Notes: Office/Warehouse space with 1 restroom and 1 grade-level roll-up door.

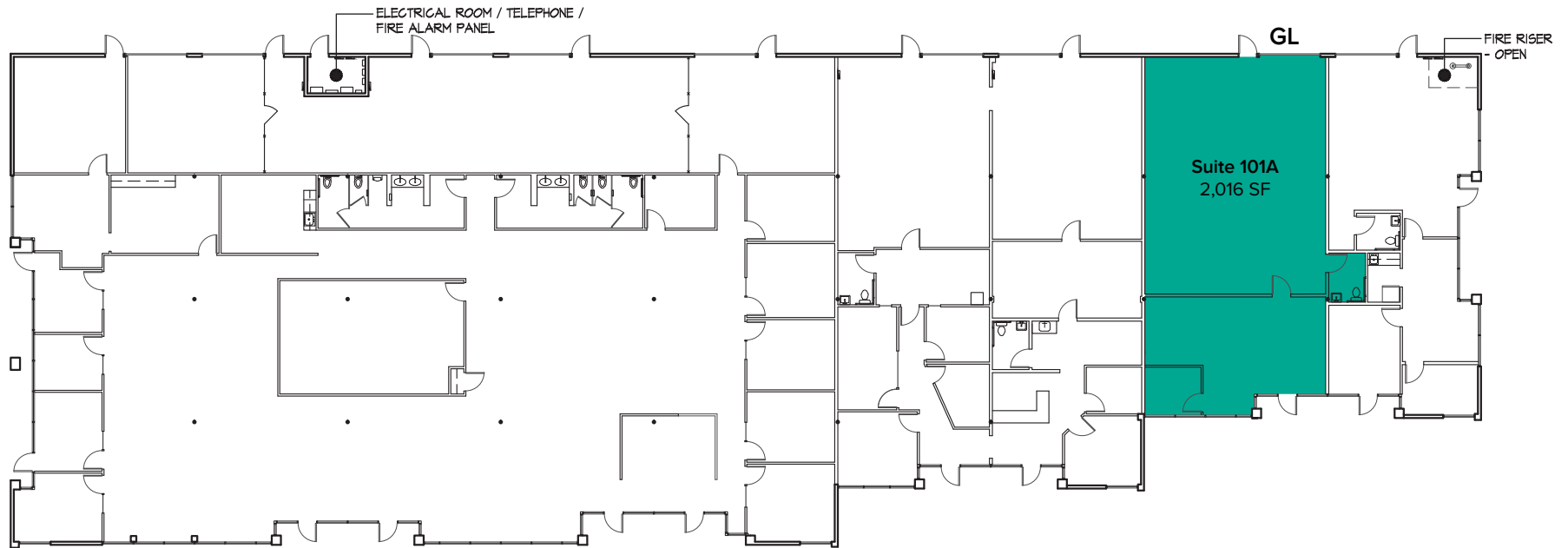

The information provided herein has been obtained from sources believed to be reliable, but no representation or warranty, express or implied, is made with respect to the accuracy or completeness of any such information. Each prospective buyer or tenant should independently investigate, evaluate and verify all information provided herein and any other matters deemed material. Please consult your attorney, tax advisor or other professional advisor. The terms of sale or lease set forth herein are subject to change or withdrawal at any time and without notice.

# CORPORATE NEIGHBORS



## LEGEND:

- 01 AT&T
- 02 Valeant Solta Medical
- 03 General Dynamics
- 04 LuxerCare
- 05 ADT Security
- 06 Google
- 07 AT&T
- 08 United Healthcare Services
- 09 Progressive, Banner Bank
- 10 HUB International
- 11 State Farm
- 12 Talentwise
- 13 Puget Sound Energy
- 14 Tetra Tech
- 15 T-Mobile

**DRIVE TIMES:**  
 I-405 ( — — ): 3 Minutes  
 Downtown Bothell: 6 Minutes  
 Downtown Woodinville: 6 Minutes

