

SMARTCAP ARLINGTON AIR

17212 51st Avenue, Arlington, WA 98223

WAREHOUSE FOR SUBLEASE

7,677 SF (549 SF ofc) Available

Warehouse rate: \$1.00/SF, NNN

Office rate: Call Agent

PROPERTY DETAILS:

- Newly constructed building
- Abundant parking
- Quick access to SR-531 and I-5

WAREHOUSE DETAILS:

- Sublease Expires: 6/30/2025
- 2 Dock-high loading doors
- 1 Grade-level loading door
- 24' Clear height
- Power: 480v Three Phase

To Schedule a tour/Request Info, contact:

Jack Rosen

425.289.2221

jack@rosenharbottle.com



The information provided herein has been obtained from sources believed to be reliable, but no representation or warranty, express or implied, is made with respect to the accuracy or completeness of any such information. Each prospective buyer or tenant should independently investigate, evaluate and verify all information provided herein and any other matters deemed material. Please consult your attorney, tax advisor or other professional advisor. The terms of sale or lease set forth herein are subject to change or withdrawal at any time and without notice.

BUILDING A FLOOR PLAN

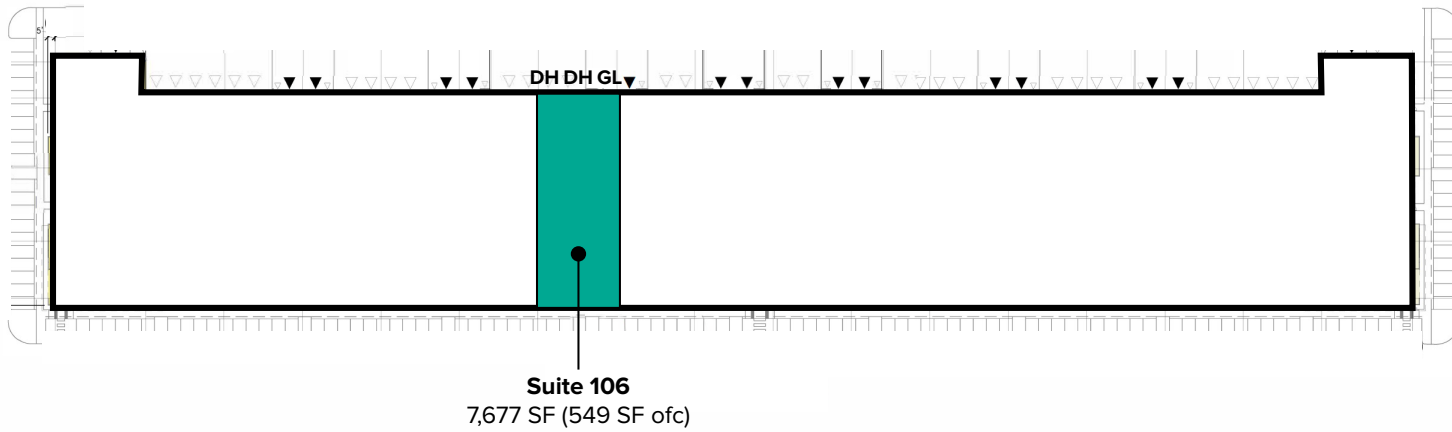

The information provided herein has been obtained from sources believed to be reliable, but no representation or warranty, express or implied, is made with respect to the accuracy or completeness of any such information. Each prospective buyer or tenant should independently investigate, evaluate and verify all information provided herein and any other matters deemed material. Please consult your attorney, tax advisor or other professional advisor. The terms of sale or lease set forth herein are subject to change or withdrawal at any time and without notice.

LOCATION MAP

