

OFC/WHSE
LEASE

Available

Available

Redmond-Fall City Road NE

EASTLAKE BUSINESS PARK, Building A & C

18336-18398 Redmond-Fall City Road | Redmond, WA 98052

Caleb Farnworth, CCIM

425.289.2235

calebf@rosenharbottle.com

425.454.3030
rosenharbottle.com

PO Box 5003
Bellevue, WA 98009 - 5003





EASTSIDE AVAILABILITIES: SMALL, OFC/WHSE SPACES

1,708 SF - 7,133 SF Available

BUILDING DETAILS:

- Professional, Business Park Setting
- Quick Access to SR 520, Union Hill & Downtown Redmond
- Nearby Amenities Include Home Depot, Whole Foods, Chipotle, Target, Kohl's, Costco & More
- Located Minutes From Future Light Rail Stations

BUILDING A FLOOR PLAN

Suite	Square Feet	Rent	Notes
18356	3,351 SF (285 SF ofc)	\$3,636/Month, NNN	End cap warehouse/office space with 1 restroom and 2 GL doors. Available now.
18358	3,782 SF (667 SF ofc)	\$4,200/Month, NNN	First floor warehouse/office space with open office area, 1 restroom, and 2 GL doors. Available now.
Contiguous	7,133 SF (952 SF ofc)	\$7,350/Month, NNN	Available now.

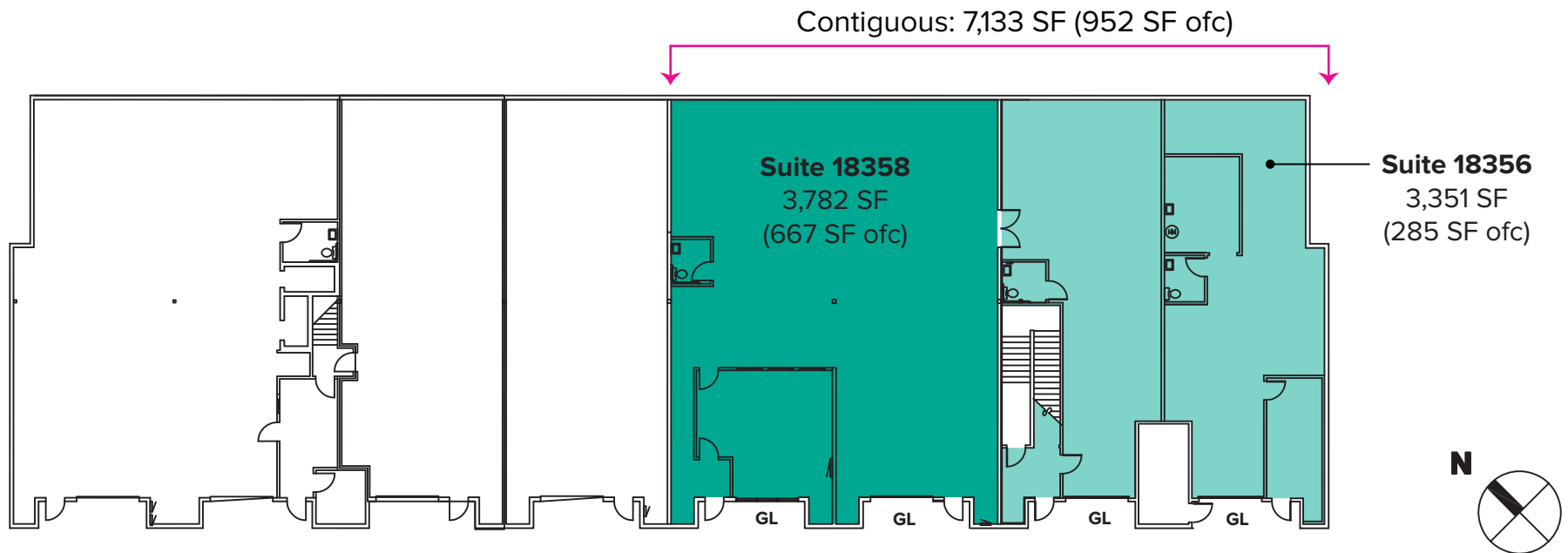

BUILDING C FLOOR PLAN

SUITE 18350 FEATURES

- Available Now
- 1,708 SF (974 SF ofc)
- \$2,682/Month, NNN
- 3 Private Offices
- 1 Restroom
- Reception Area
- Warehouse Space
- 1 GL Roll-up Loading Door
- 14' - 16' Clear Height in Warehouse

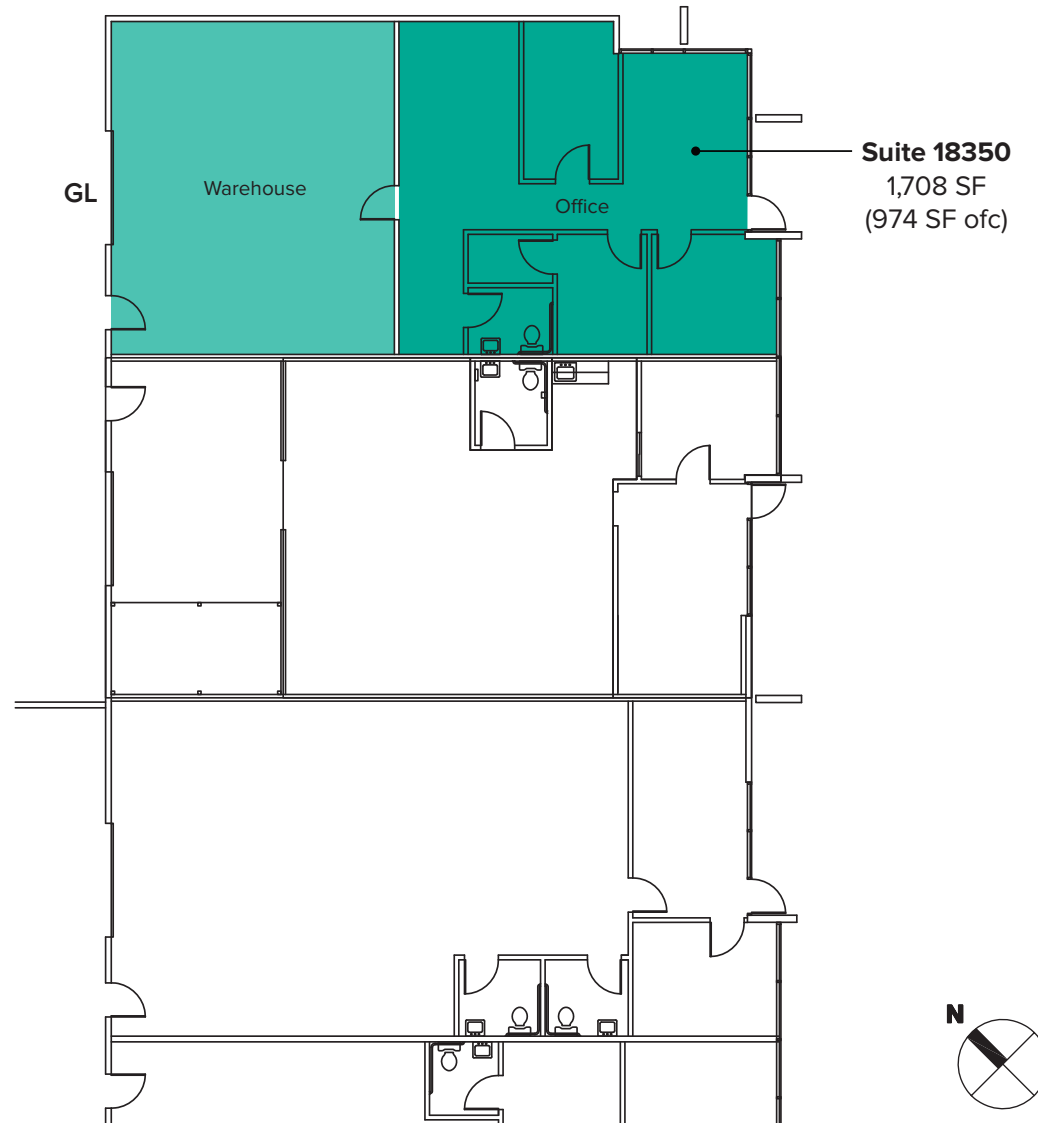

LOCATION MAP

