

WAREHOUSE
LEASE

Available

B

EVERGREEN INDUSTRIAL CENTER

19510 144th Avenue NE, Woodinville, WA

Caleb Farnworth, CCIM

425.289.2235

calebf@rosenharbottle.com

425.454.3030
rosenharbottle.com

PO Box 5003
Bellevue, WA 98009 - 5003



WOODINVILLE WAREHOUSE SPACE AVAILABLE

7,982 SF (1,816 SF OFC)

First Floor Office: \$2.20/SF, NNN

Second Floor Office: \$1.75/SF, NNN

Warehouse: \$1.20/SF, NNN

SUITE FEATURES:

- **Available Q1 2023**
- 20' - 24' Clear Height
- Sprinkled and 3-Phase Power
- Building Signage Along 144th Avenue
- 1 Grade-level Door
- 1 Dock-High Door
- First floor & second floor office area
- Clear span warehouse
- 3 Restrooms
- Quick Access to SR 522 and I-405

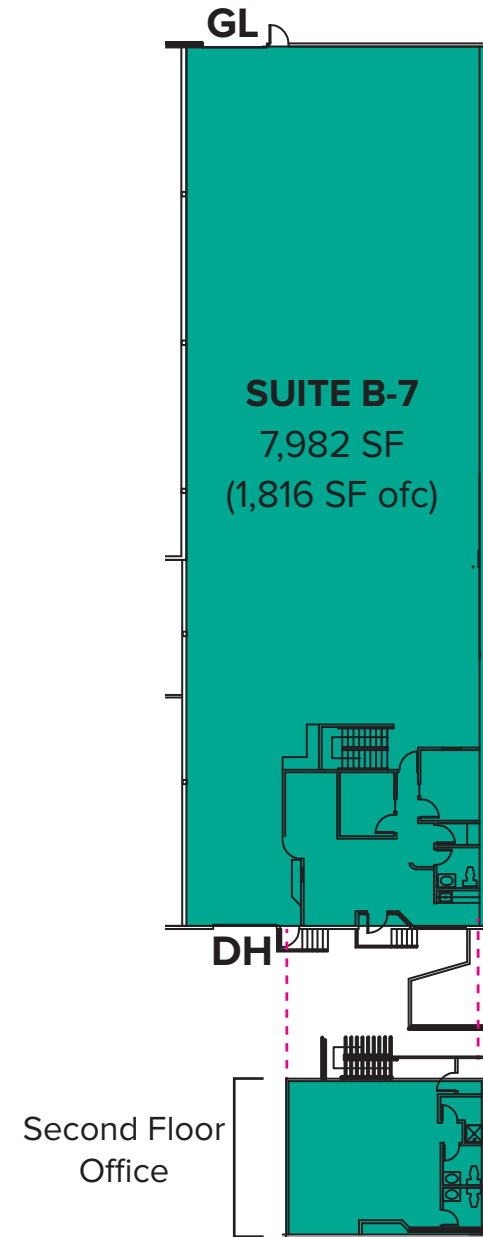

LOCATION MAP

