



**HIGH-VISIBILITY RETAIL ON
NE 20th Street**



COLUMBIA PLAZA BUILDING A

13433 NE 20th Street, Bellevue, WA 98005

Brian Stewart
425.289.2222
brians@rosenharbottle.com

Jack Rosen
425.289.2221
jack@rosenharbottle.com

Caleb Farnworth, CCIM
425.289.2235
caleb@rosenharbottle.com

425.454.3030
rosenharbottle.com

PO Box 5003
Bellevue, WA 98009 - 5003





Current Building

NEW BUILDING RENOVATIONS TO BE COMPLETED Q1/2021

\$34.00 - \$38.00/SF, NNN

1,250 SF - 10,500 SF

FEATURES:

- Retail signage on NE 20th Street
- Located in the heart of the Bel-Red corridor
- Quick access to SR-520 and I-405
- Close proximity to future Bel-Red Light Rail Station
- New building renovations to be completed February 2020
- 23,218+ Cars per day



New South Elevation Renovations

| Daytime Population | 1 Mile | 2 Mile | 3 Mile |
|--------------------|--------|--------|---------|
| 2019 | 15,525 | 64,549 | 132,512 |
| 2024 | 17,398 | 70,363 | 143,684 |

FIRST LEVEL FLOOR PLAN

Contiguous 10,500 SF

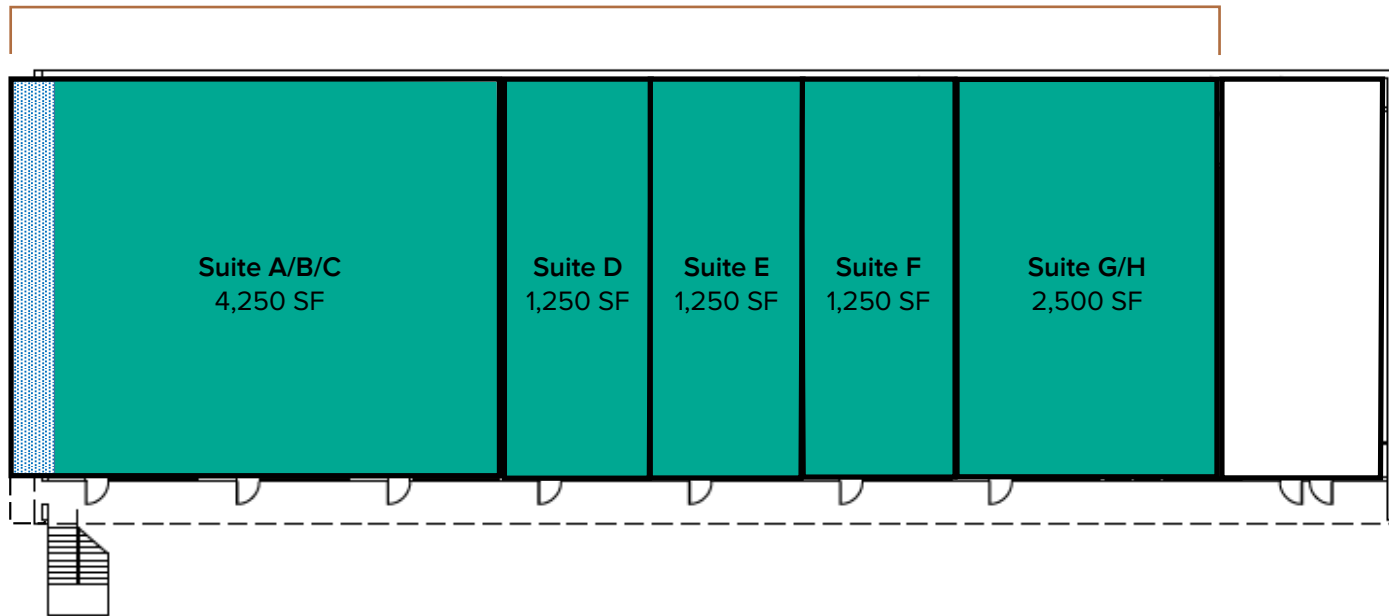

SECOND LEVEL FLOOR PLAN



LOCATION MAP

