



RETAIL  
LEASE

# HILLSIDE PLAZA SHOPPING CENTER

2000 - 2222 S 314th Street | Federal Way, WA

**Grant Rubenstein**

425.289.2220

grant@rosenharbottle.com

**Stossi Tsantilas**

425.279.7943

stossit@rosenharbottle.com

425.454.3030  
rosenharbottle.com

PO Box 5003  
Bellevue, WA 98009 - 5003





# FLEXIBLE RETAIL SPACE CONFIGURATIONS

**\$19.50/SF, NNN**

**4,865 SF - 10,205 SF Available**

## FEATURES:

- Blocks Away from The Commons, I-5, Hwy 99, Transit Center, & Future Link Light Rail Station
- Directly Adjacent to Performing Arts & Events Center
- Great Tenant Mix: Gene Juarez, CSL Plasma, Nail & Beauty Salon, and Elev8 Hot Yoga
- Densely Populated Surrounding Neighborhoods

The information provided herein has been obtained from sources believed to be reliable, but no representation or warranty, express or implied, is made with respect to the accuracy or completeness of any such information. Each prospective buyer or tenant should independently investigate, evaluate and verify all information provided herein and any other matters deemed material. Please consult your attorney, tax advisor or other professional advisor. The terms of sale or lease set forth herein are subject to change or withdrawal at any time and without notice.

# FLOOR PLAN

Suite	Square Feet	Rate	Notes
2004	4,865 SF	\$19.50/SF NNN	Retail space with great visibility. <b>Available with 45 days' notice.</b>
2030	10,205 SF	\$19.50/SF NNN	Existing school space. Includes 4 classrooms, expanded restrooms, offices, reception, break room, 1 grade-level loading door, and 1 dock-high loading door. <b>Available now.</b>
2144	8,956 SF	\$19.50/SF NNN	Large retail space with open floor plan. <b>Available with 45 days' notice.</b>

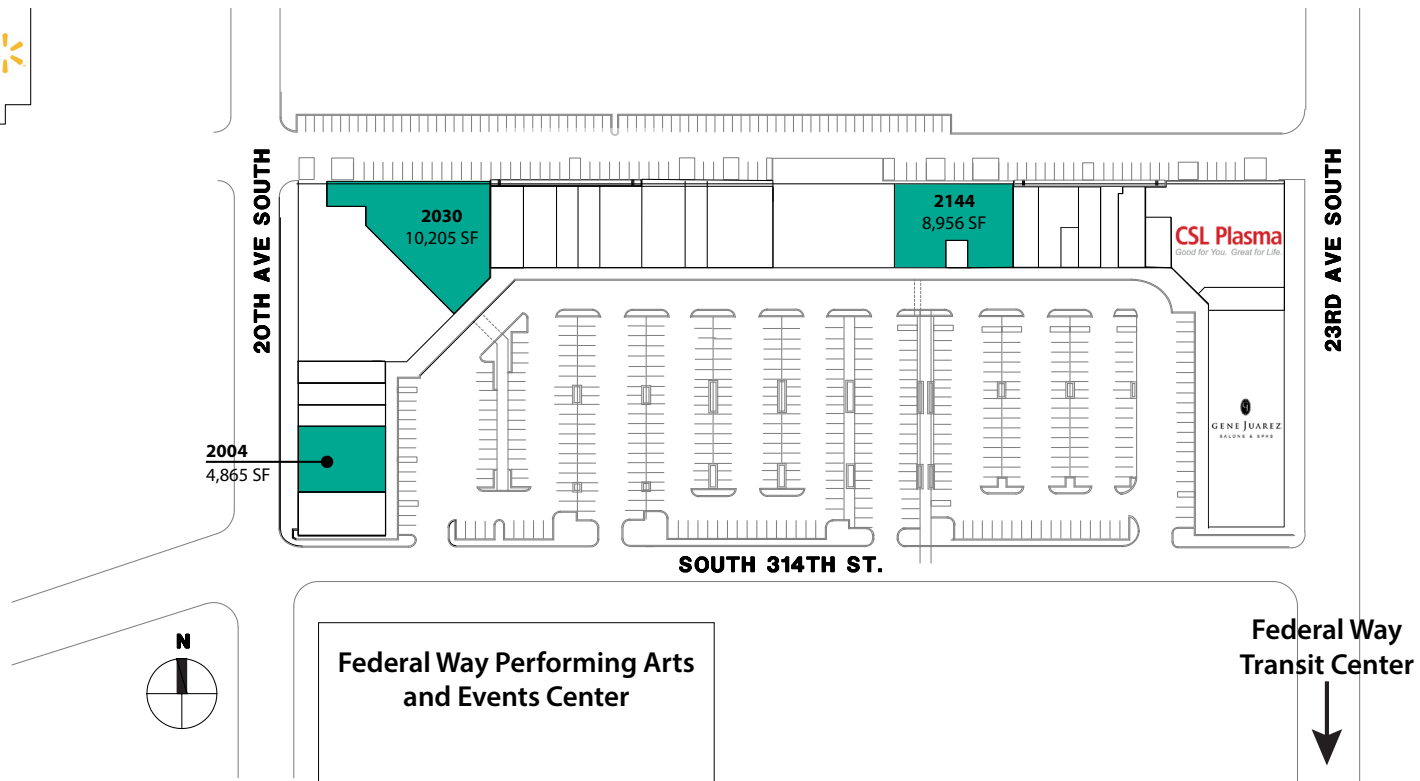

The information provided herein has been obtained from sources believed to be reliable, but no representation or warranty, express or implied, is made with respect to the accuracy or completeness of any such information. Each prospective buyer or tenant should independently investigate, evaluate and verify all information provided herein and any other matters deemed material. Please consult your attorney, tax advisor or other professional advisor. The terms of sale or lease set forth herein are subject to change or withdrawal at any time and without notice.

# LOCATION MAP

