

WHSE/OFC
LEASE

Available

WILLOWS PARK I & II, Building C

15205 - 15265 NE 95th Street | Redmond, WA 98052

Grant Rubenstein

425.289.2220

grant@rosenharbottle.com

425.454.3030
rosenharbottle.com

PO Box 5003
Bellevue, WA 98009 - 5003





OFFICE / WAREHOUSE SPACE AVAILABLE

\$1.90/SF Ofc | \$0.90/SF Whse, NNN

25,016 SF (13,061 SF ofc)

DETAILS:

- Available 12/1/2020
- 5 Grade-Level Doors
- 1 Dock-High Loading
- 16' - 18' Clear Height
- Quality Concrete Tilt-Up Construction
- Building Signage Available
- Close-In Redmond Location

SUITE 15225 FLOOR PLAN

Total SF	Warehouse Rate	Office Rate	Available
25,016 SF	\$0.90/SF, NNN	\$1.90/SF, NNN	12/1/2020

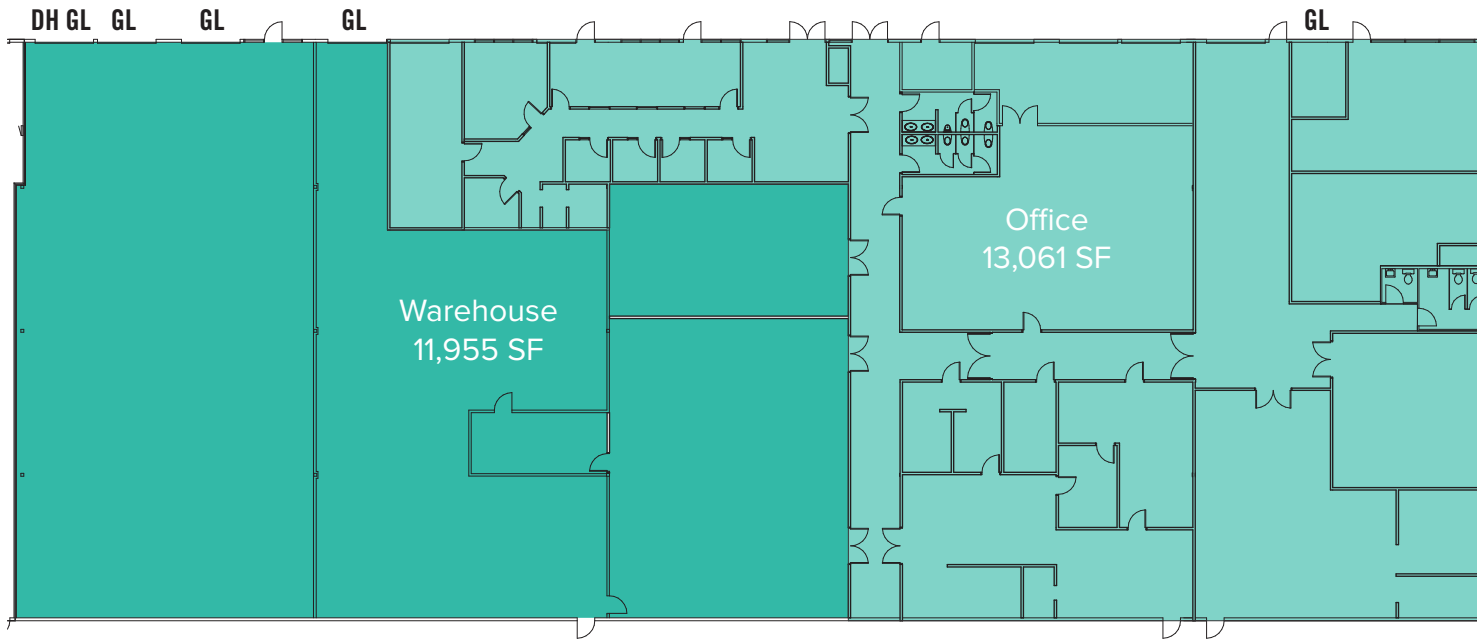

SITE PLAN

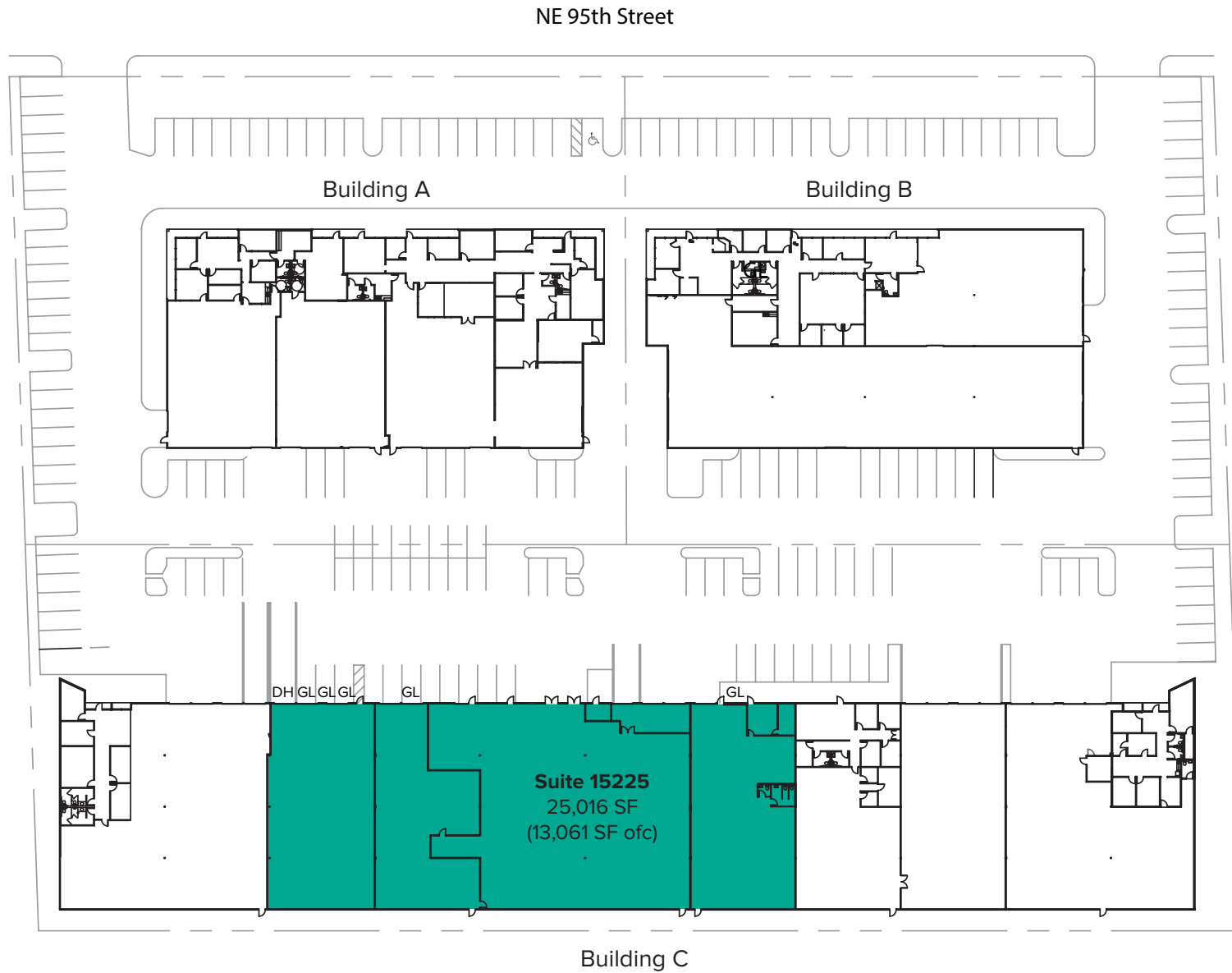

LOCATION MAP

