

# BEAR CREEK PLAZA

19011 Woodinville-Snohomish Road NE, Woodinville, WA 98072



## Office Near Downtown Woodinville

1,194 SF - 3,978 SF Available

\$14.50 - \$18.00/SF, Gross

### BUILDING FEATURES:

- Quick Access to SR-522 & I-405
- High Visibility to Woodinville-Snohomish Road & SR-522
- Building Signage Available
- Elevator
- Abundant Parking
- Close to Downtown Woodinville, Costco & Wineries
- Tenant Improvement Dollars Available



For more information, contact:

**ROSEN~HARBOTTLE  
COMMERCIAL REAL ESTATE**

**Caleb Farnworth, CCIM**

(425) 289-2235

calebf@rosenharbottle.com

www.rosenharbottle.com

Rosen~Harbottle Commercial Real Estate | P.O. Box 5003 Bellevue, WA 98009-5003  
phone: (425) 454-3030 fax: (425) 454-6705 | [www.rosenharbottle.com](http://www.rosenharbottle.com)

The information provided has been obtained from sources believed reliable. While we do not doubt its accuracy, we have not verified and make no guarantee, warranty or representation about it. It is your sole responsibility to independently confirm its accuracy and completeness.

# BEAR CREEK PLAZA

19011 Woodinville-Snohomish Road NE, Woodinville, WA 98072

## SECOND FLOOR

### Suite 270 - 1,761 SF

- 3 POs, Reception, Open Area, Sink
- Conference Room, Storage Room
- Good Natural Light

### Suite 250 - 2,217 SF

- Ideal for Open Office or Recreational Use
- 1 PO, Reception, Open Area
- Build-to-Suit Available

### Suite 230 - 1,194 SF

- Open Space
- Good Natural Light
- High Ceilings with Exposed Beams

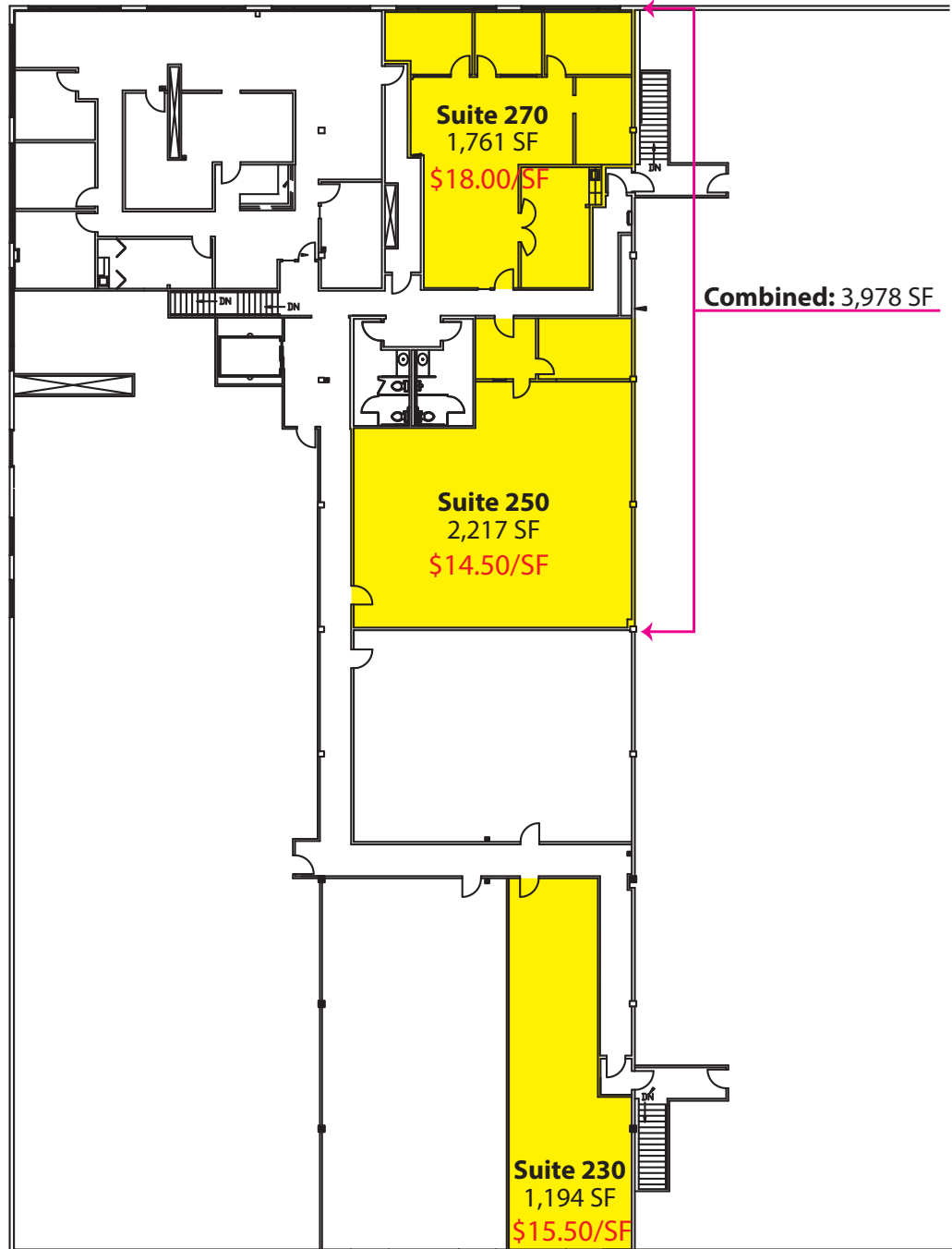

Rosen~Harbottle Commercial Real Estate | P.O. Box 5003 Bellevue, WA 98009-5003  
phone: (425) 454-3030 fax: (425) 454-6705 | [www.rosenharbottle.com](http://www.rosenharbottle.com)

The information provided has been obtained from sources believed reliable. While we do not doubt its accuracy, we have not verified and make no guarantee, warranty or representation about it. It is your sole responsibility to independently confirm its accuracy and completeness.

# BEAR CREEK PLAZA

19011 Woodinville-Snohomish Road NE, Woodinville, WA 98072



For more information, contact:

**ROSEN~HARBOTTLE  
COMMERCIAL REAL ESTATE**

**Caleb Farnworth, CCIM**

(425) 289-2235

calebf@rosenharbottle.com

www.rosenharbottle.com

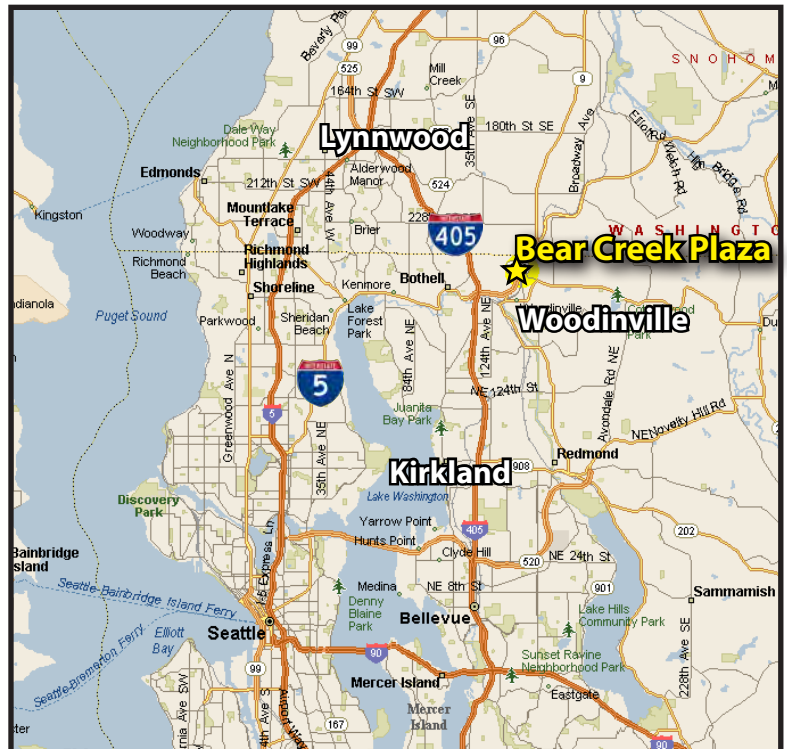

Rosen~Harbottle Commercial Real Estate | P.O. Box 5003 Bellevue, WA 98009-5003  
phone: (425) 454-3030 fax: (425) 454-6705 | www.rosenharbottle.com

The information provided has been obtained from sources believed reliable. While we do not doubt its accuracy, we have not verified and make no guarantee, warranty or representation about it. It is your sole responsibility to independently confirm its accuracy and completeness.