

**WAREHOUSE
LEASE**

Available



EVERGREEN INDUSTRIAL CENTER

19510 144th Avenue NE, Woodinville, WA

Caleb Farnworth, CCIM

425.289.2235

calebf@rosenharbottle.com

425.454.3030
rosenharbottle.com

PO Box 5003
Bellevue, WA 98009 - 5003



CLEARSPAN WAREHOUSE

\$1.00/SF, NNN

7,000 SF (537 SF ofc)

FEATURES:

- Quick Access to SR 522 and I-405
- 24' Clear Height
- Sprinkled and 3-Phase Power
- 1 Grade-level and 1 Dock-High door
- Floor drains and winery improvements
- Available on 4/1/2020



FLOOR PLAN

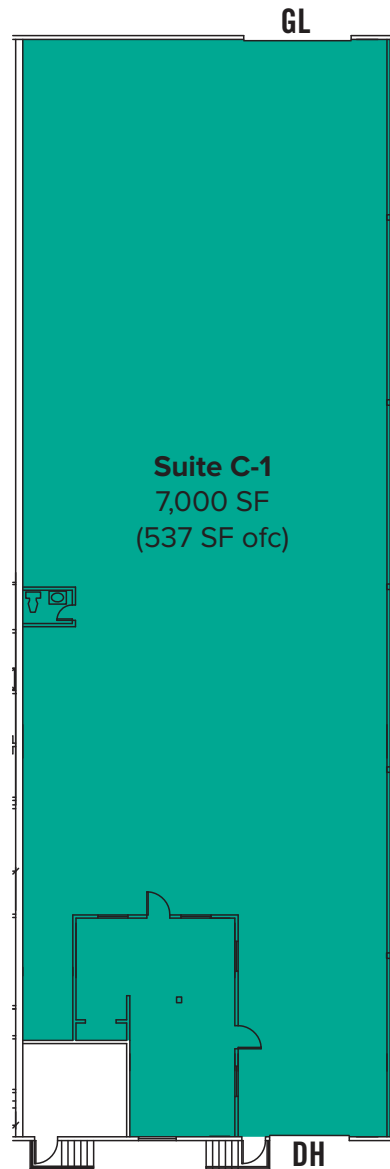

LOCATION MAP

