



**SOUTHCENTER  
RETAIL LEASE**

# PARKWAY SQUARE SHOPPING CENTER

16600 - 16890 Southcenter Parkway | Tukwila, WA

**Jack Rosen**  
425.289.2221  
jack@rosenharbottle.com

**Brian Stewart**  
425.289.2222  
brians@rosenharbottle.com

425.454.3030  
rosenharbottle.com

PO Box 5003  
Bellevue, WA 98009 - 5003





# HIGH-EXPOSURE RETAIL CENTER

## 1,400 SF - 3,838 SF Available

### PROPERTY FEATURES:

- Prominent Signage on Southcenter Parkway
- Immediate access to I-5 & I-405
- One block away from Westfield-Southcenter Mall
- Tenants Include: Jared Jewelers, Max's, Miyabi Sushi, and Bai Tong Thai
- 28,520+ cars per day on Southcenter Parkway
- Neighboring Retailers: Target, Kohl's, Nordstrom Rack, Best Buy, Dick's Sporting Goods, BevMo!, & Ashley's Furniture Homestore
- Abundant parking

### DEMOGRAPHICS:

	1 Mile	3 Miles	5 Miles
Population	6,169	70,063	288,133
Avg. HH Income	\$91,382	\$81,997	\$87,888
Daytime Population	15,571	103,719	247,090



The information provided herein has been obtained from sources believed to be reliable, but no representation or warranty, express or implied, is made with respect to the accuracy or completeness of any such information. Each prospective buyer or tenant should independently investigate, evaluate and verify all information provided herein and any other matters deemed material. Please consult your attorney, tax advisor or other professional advisor. The terms of sale or lease set forth herein are subject to change or withdrawal at any time and without notice.

# SITE PLAN

Suite	Square Feet	Rate/Rent	Notes
16600-A	~ 3,838 SF	Call Agent	End cap space available with frontage on Southcenter Pkwy & visibility to I-5.
16832	2,736 SF	\$3,967/Month, Mod Gross	Industrial Space with 2 Restrooms, 2 Private Offices, and 3 Auto-Grade-Level Doors.
16864	1,400 SF	\$35.00/SF, NNN	Retail/Restaurant space with open area and 1 restroom. <b>Available 10/1/2021.</b>

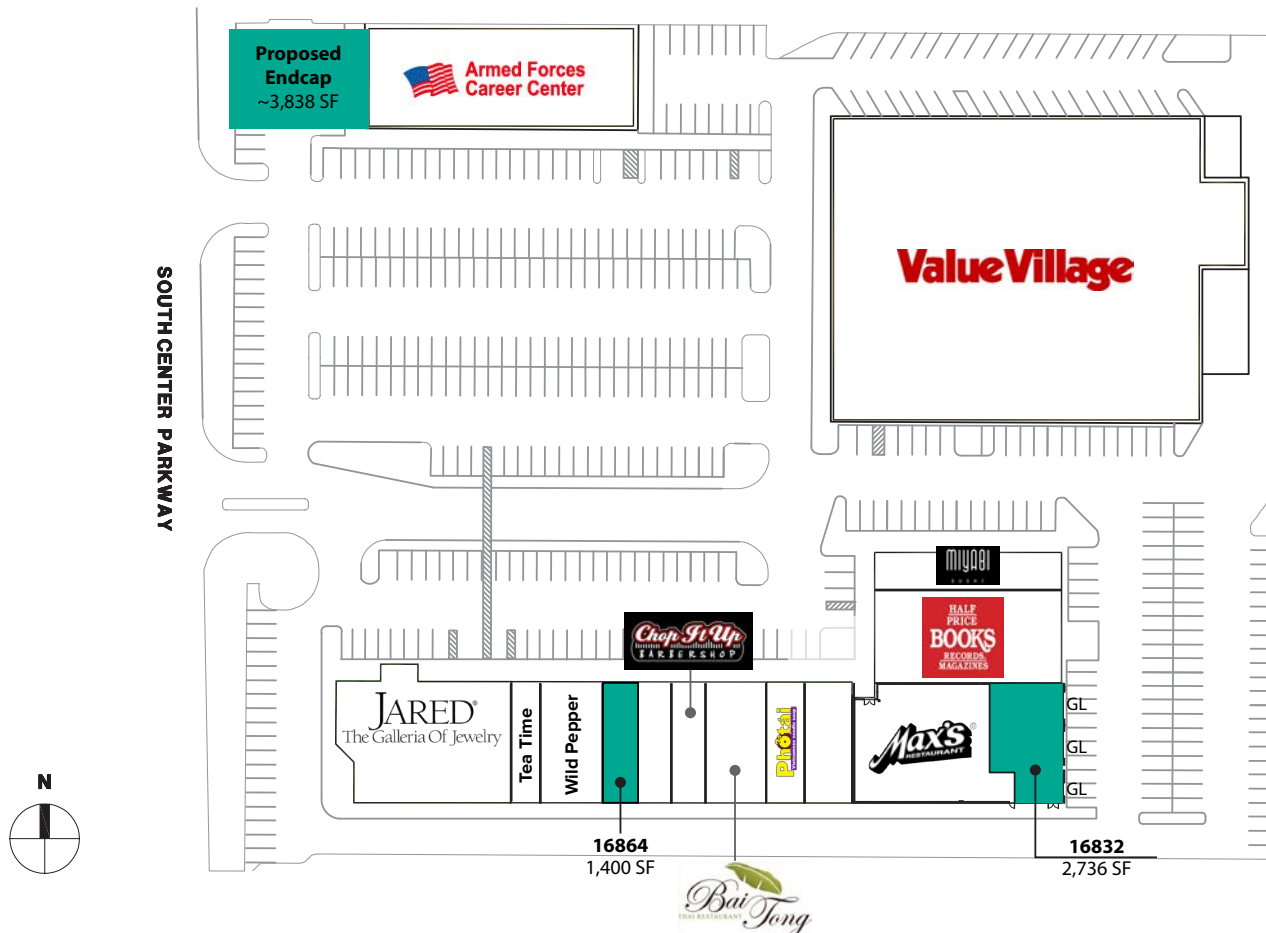

The information provided herein has been obtained from sources believed to be reliable, but no representation or warranty, express or implied, is made with respect to the accuracy or completeness of any such information. Each prospective buyer or tenant should independently investigate, evaluate and verify all information provided herein and any other matters deemed material. Please consult your attorney, tax advisor or other professional advisor. The terms of sale or lease set forth herein are subject to change or withdrawal at any time and without notice.

# SUITE 16864 FLOOR PLAN

## FEATURES:

- **Available 10/1/2021**
- 1,400 SF
- Retail/Restaurant Space
- \$35.00/SF, NNN
- Open retail area
- Back Room
- 1 Restroom

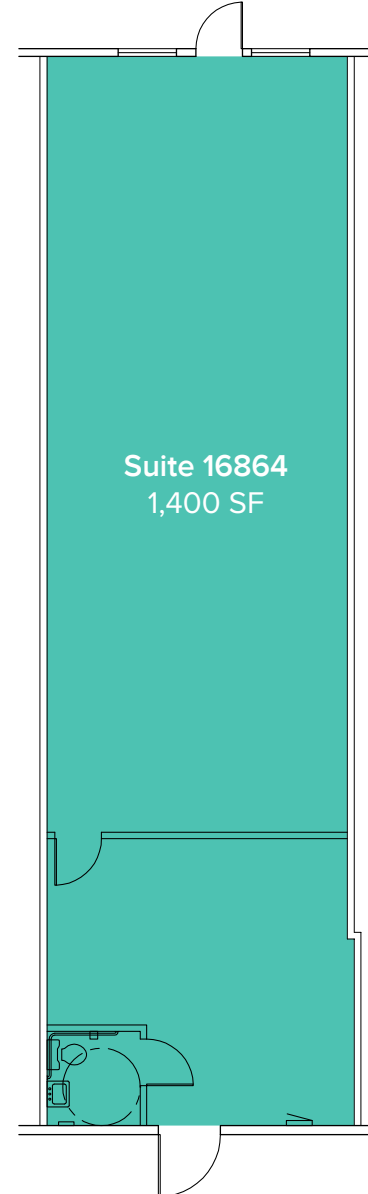

# SUITE 16832 FLOOR PLAN

## FEATURES:

- **Available Now**
- 2,736 SF
- Rare Warehouse space
- \$3,967/Month, Modified Gross
- 2 Restrooms
- 2 Private offices
- 3 Auto grade-level doors

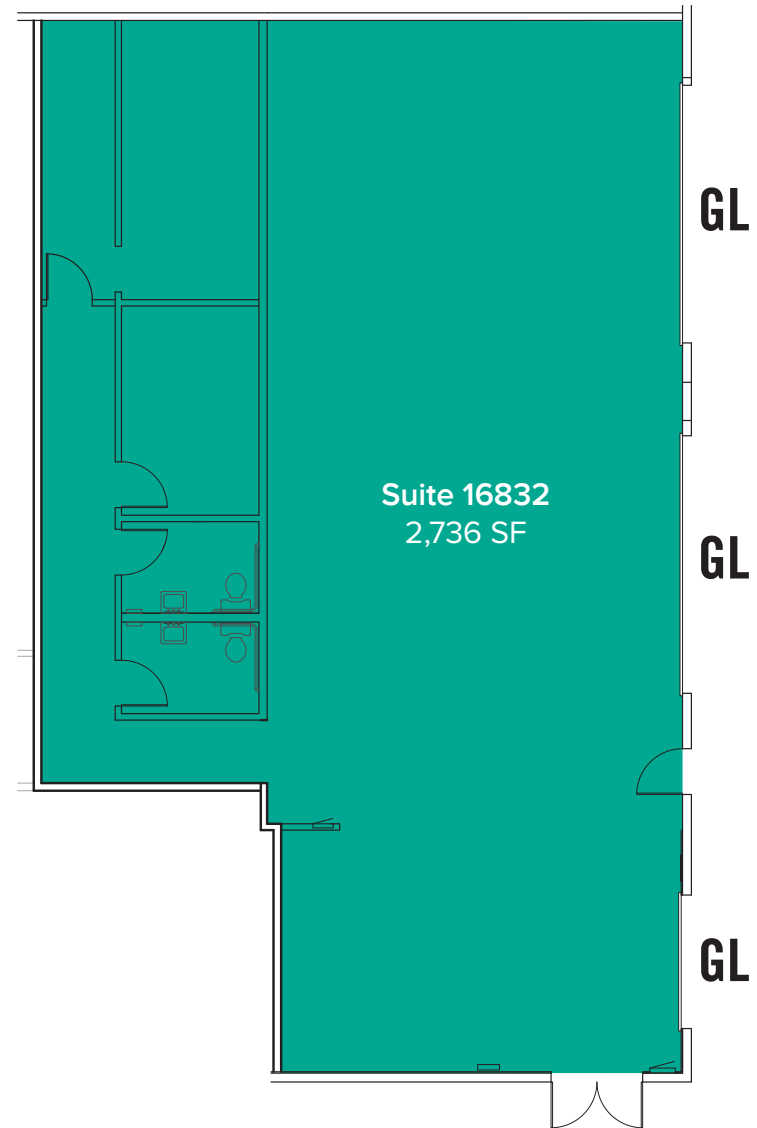



# LOCATION MAP

