



**HIGH-VISIBILITY RETAIL ON  
NE 20th Street**



# **COLUMBIA PLAZA BUILDING A**

**13433 NE 20th Street, Bellevue, WA 98005**

**Caleb Farnworth, CCIM**

425.289.2235

calebf@rosenharbottle.com

**Jack Rosen**

425.289.2221

jack@rosenharbottle.com

**Brian Stewart**

425.289.2222

brians@rosenharbottle.com

425.454.3030  
rosenharbottle.com

PO Box 5003  
Bellevue, WA 98009 - 5003





*Current Building*

# NEW BUILDING RENOVATIONS TO BE COMPLETED Q1/2021

**\$34.00 - \$38.00/SF, NNN**

**1,250 SF - 10,500 SF**

## FEATURES:

- Retail signage on NE 20th Street
- Located in the heart of the Bel-Red corridor
- Quick access to SR-520 and I-405
- Close proximity to future Bel-Red Light Rail Station
- New building renovations to be completed February 2020
- 23,218+ Cars per day



*New South Elevation Renovations*

Daytime Population	1 Mile	2 Mile	3 Mile
2019	15,525	64,549	132,512
2024	17,398	70,363	143,684

# FIRST LEVEL FLOOR PLAN

Contiguous 10,500 SF

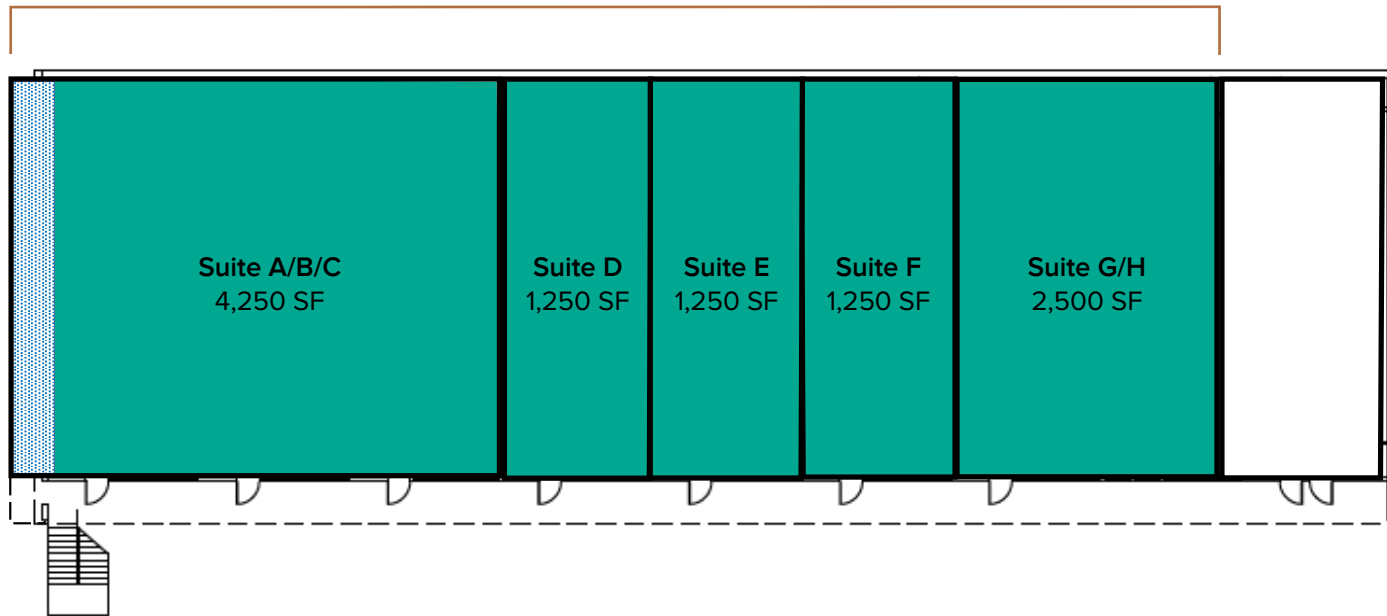

# SECOND LEVEL FLOOR PLAN





# LOCATION MAP

