

OFC/WHSE
LEASE

arborCHURCH

RET AVAILABLE 425-454-3030

BEAR CREEK PLAZA

19011 Woodinville-Snohomish Road NE | Woodinville, WA

Caleb Farnworth, CCIM

425.289.2235

calebf@rosenharbottle.com

425.454.3030
rosenharbottle.com

PO Box 5003
Bellevue, WA 98009 - 5003





HIGH-VISIBILITY TO WOODINVILLE-SNOHOMISH ROAD & SR-522

\$0.75/SF whse - \$1.30/SF ofc, NNN

17,418 SF (1,411 SF ofc)

FEATURES:

- Abundant Parking
- Sprinkled Building
- Grade-Level and Dock-High Loading
- Building Signage Available
- Close to Downtown Woodinville, Costco, Industrial Area, and Wineries
- Quick Access to SR-522 and I-405

FLOOR PLAN

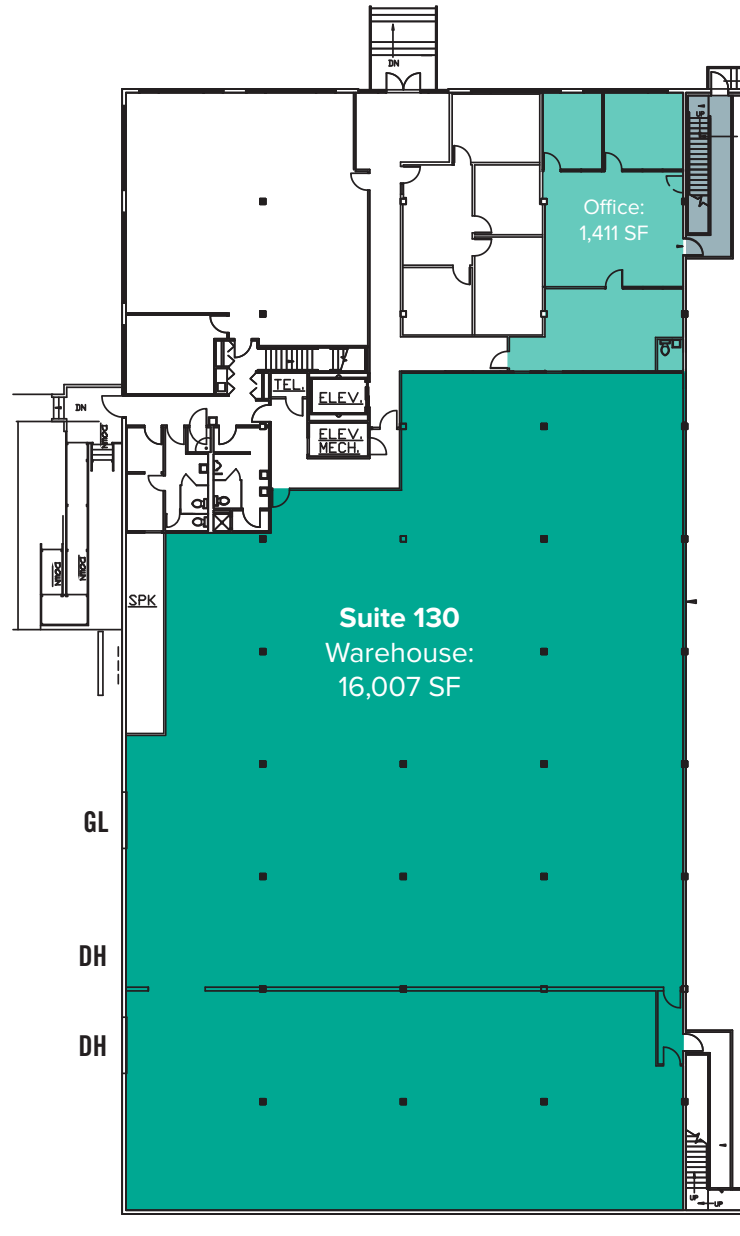

LOCATION MAP



LEGEND:

- 01 Hagggen
- 02 AMC Woodinville 12
- 03 Target
- 04 Gold's Gym
- 05 DiStefano Winery Ltd
- 06 Locust Cider & Brewing
- 07 Triplehorn Brewing Co
- 08 Elevation Cellars
- 09 Kestrel Vintners
- 10 Eye of the Needle Winery
- 11 20 Corners Brewing
- 12 Advantage Gymnastics Academy
- 13 Precor Incorporated
- 14 Costco
- 15 Restaurant Depot