

RETAIL
LEASE

Available

5th Avenue S

Maple Street

OLD MILL TOWN, BOARDWALK

203 5th Avenue S | Edmonds, WA

Brian Stewart
425.289.2222
brians@rosenharbottle.com

Jack Rosen
425.289.2221
jack@rosenharbottle.com

425.454.3030
rosenharbottle.com

PO Box 5003
Bellevue, WA 98009 - 5003





RARE RETAIL IN THE HEART OF DOWNTOWN EDMONDS

876 SF - 1,485 SF Available

DETAILS:

- Shared Space with Hazel Miller Plaza
- Building Signage Available
- Located in Historic Downtown Edmonds
- Minutes from Edmonds/Kingston Ferry
- Many Amenities within Walking Distance

BOARDWALK FLOOR PLAN

| Suite | Square Feet | Rent | Available |
|-------|-------------|--------------------|-----------------|
| 1 | 1,485 SF | Call Agent | 30 Days' Notice |
| 2 | 876 SF | \$2,774/Month, NNN | Now |

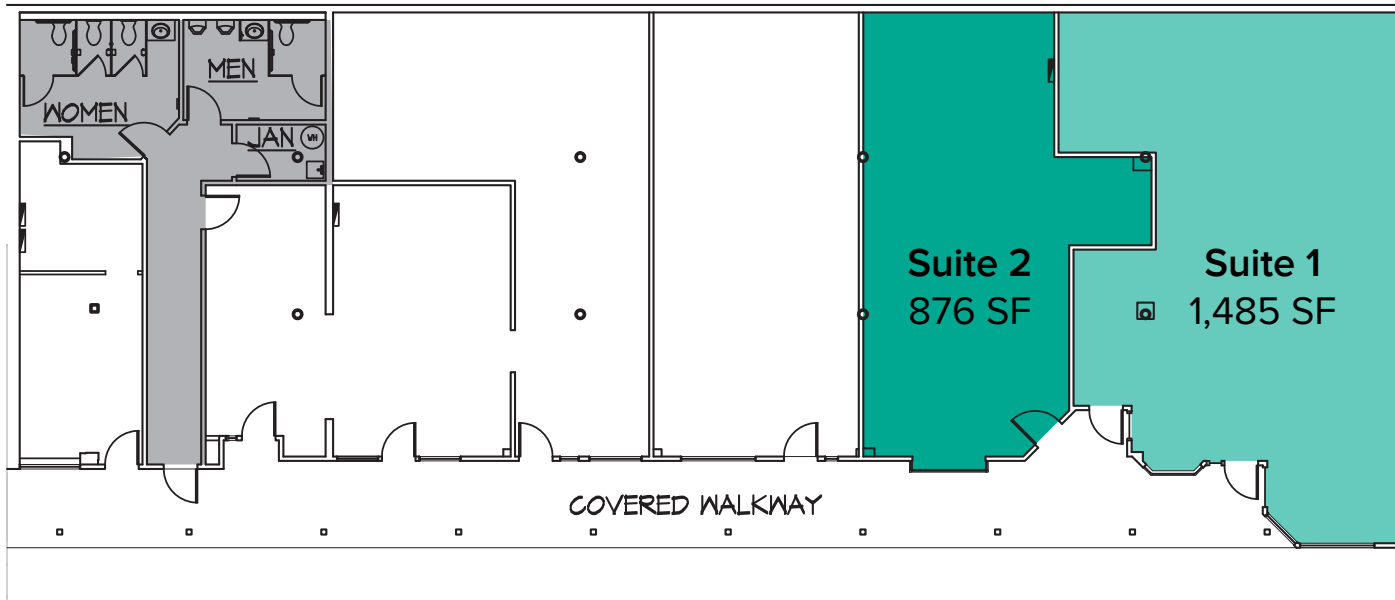

LOCATION MAP

